

INTERIOR MOULDING & TRIM



METRIE.

THE ART OF FORM





METRIE.

THE ART OF FORM

WHO WE ARE

Since our beginnings as a small family-owned business in 1926, our dedication to creating high-quality, finely crafted architectural elements has helped us grow to become the largest supplier and manufacturer of solid wood and composite moulding in North America.

METRIE.COM

DESIGN – PARTNERSHIP – CRAFTSMANSHIP



Our success is driven by a commitment to deliver excellence rooted in design, partnership and craftsmanship.

We believe beauty is in the details, and know that even the smallest of details adds up to create big differences.

Design is in our DNA, and permeates many aspects of our business. Our teams work on everything from trend forecasting to creating new profiles that meet the needs of our customers and homeowners.

We design and craft relationships you can count on – partnerships you can rely on. We collaborate with our partners while listening and talking to designers, architects, builders and contractors – adding value throughout the supply chain.



Our attention
to the details
helps people
create beautiful
interior spaces.
Spaces to live,
work and to truly
call home.



FIND US, FOLLOW US, LIKE US & WATCH US!



MANUFACTURING EXCELLENCE

Metrie operates five domestic manufacturing facilities between the U.S. and Canada. Our solid and finger-jointed wood mills are located close to their respective fiber sources to minimize the costs and environmental impacts of transportation while ensuring that all raw materials are responsibly sourced. Our state-of-the-art MDF mills are technologically advanced and designed for efficient operations, reflecting our customer commitment to delivering finely crafted, high quality products.



UNMATCHED QUALITY

Our mills allow us the flexibility to provide the right solutions to the markets we serve, understanding regional differences and adhering to strict specification standards. In addition, we have the ability to design, test and produce exclusive profiles to satisfy a custom order or to stay on top of the latest home trends. We have full in-house CAD capabilities and use computer-generated templates to manufacture profiles to extremely tight tolerances. Metrie has built a reputation for setting some of the highest industry standards.



RESPONSIBLE ACTIONS

With fine craftsmanship comes responsibility, and we are committed to being responsible stewards of forest resources. We strive to maximize the yield from every board using variable width and multiple rip-saws. Our resaws use ultra-thin blades to minimize saw kerf and any products that do not meet our length criteria are manufactured into finger-joint blocks to eventually become finger-jointed mouldings.



TheFinishedSpace.com



Facebook.com/OfficialMetrie



Twitter.com/OfficialMetrie



Instagram.com/OfficialMetrie



LinkedIn.com/Company/Metrie



Pinterest.com/OfficialMetrie



YouTube.com/OfficialMetrie



Houzz.com/pro/Metrie

TABLE of Contents

- 6 Architraves
- 7 Astragals
- 8 Baseboards
- 18 Baseboard Caps & Shoes
- 19 Casings
- 27 Corner Guards
- 28 Crowns
- 32 Door Stops
- 33 Flat Stock
- 34 Jambs
- 35 Miscellaneous
- 42 Notes
- 43 Index



Storage, Handling and Preparation of all Mouldings and S4S Boards

Prior to installation, it is important to acclimate your moulding and trim products by storing them in the installation space for at least 3 days. Wood and wood based products can expand and contract depending on internal and external environmental moisture levels. For best results, be sure to store products in a dry location and transport only if fully protected from water. Keep products clean from dirt and debris and finish according to paint and stain manufacturers' recommendations.



- 1 ARCHITRAVES:** In classical architecture, it described the main beam resting on the tops of the columns. Today it is often used as a decorative moulding for ornamentation or finishing at the top of windows and doors.
- 2 BASEBOARDS:** Baseboards are placed along the wall at the floor. They should be chosen to work in harmony with your casings to finish and tie the room together. Baseboards are usually thinner than the casing.
- 3 BUILD-UPS:** Combining two or more moulding profiles to create a new or custom look. Also called stacking, build-ups make it easy to create the look of custom made trimwork without the high cost.
- 4 CASINGS:** Casings define the overall character of a room and are often the most visible part of the trim. They are used primarily to cover the gap between drywall and the door or window frame. Casings are generally thicker than the base mouldings.
- 5 CROWNS:** Crowns are placed along the wall at the ceiling. They come in a wide range of patterns and sizes. Crowns soften the transition from wall to ceiling while adding a distinctive look and charm to your room.
- 6 FINISH BOARDS:** Finish Boards come in either S4S (Surfaced 4 Sides) or S3S (Surfaced 3 Sides) and are used for a multitude of purposes including shelving, window liner, bases, casing, etc.
- 7 PANEL MOULDS:** Panel Moulds are used to frame wall paneling and add an accent to your walls. Often used in furniture construction.
- 8 RAKE MOULD:** Rakes are often used as crowns. In fact, they are sometimes called "solid crowns".
- 9 WAINSCOT:** Trimwork installed in the area below a chair rail. Numerous options are available including raised panel, shadow box and beaded. Combined with a chair rail and baseboard, Wainscoting creates a dramatic look to any room.
- 10 WINDOW STOOL:** Also called window sill, a Window Stool is the surface installed below the sash of a window. Trim installed under window stool creates a distinctive look and adds a decorative touch.

ARCHITRAVES

ARCHITRAVES

High above windows and doors, architraves work to add grandeur to any space – reducing miter lines and elevating your look. A great architrave is, above all else, the dressing that's built to impress.



Stock Code
MFP5000
(1341811)

Dimensions
1 $\frac{3}{16}$ " x 3 $\frac{3}{4}$ " x 16'

MDF/UL



Stock Code
MFP5020
(1610429)

Dimensions
1 $\frac{3}{16}$ " x 5 $\frac{1}{4}$ " x 16'

MDF/UL



Stock Code
MFPU5015
(1677969)

Dimensions
1 $\frac{1}{2}$ " x 5 $\frac{1}{2}$ " x 16'

1324430
1 $\frac{1}{2}$ " x 6 $\frac{1}{2}$ " x 16'
MDF/UL

ASTRAGALS

An astragal is commonly used to seal between a pair of doors. The astragal closes the clearance gap. The vertical moulding attaches to a stile on one of a pair of doors against which the other door strikes or closes.



Stock Code	Dimensions
MSP131507 (1567303)	1¼" x 2" x 7'
MSP131508 (1567304)	1¼" x 2" x 8'

PIN



Stock Code	Dimensions
MAS130508 (1681998)	1¼" x 2" x 8'

ALD

MP130507 (1382486)	1¼" x 2" x 7'
MP130508 (1567129)	1¼" x 2" x 8'

PFJ

MSP130507 (1567300)	1¼" x 2" x 7'
MSP130508 (1567301)	1¼" x 2" x 8'

PIN

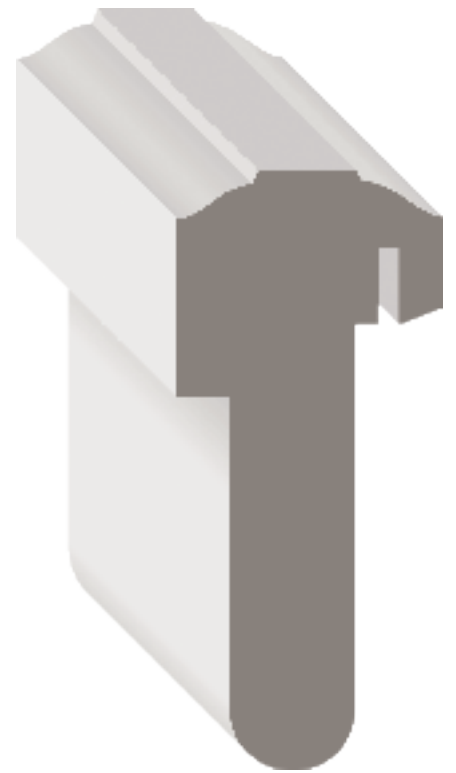

Stock Code	Dimensions
MSP130808 (1567302)	1½" x 3⅜" x 8'

PIN

BASEBOARDS

BASEBOARDS

Your look starts here – at the foundation of a room.

A great baseboard complements a casing and creates a smooth transition from the wall to the floor, guiding you seamlessly from room to room.



Stock Code
MSP726
(1567353)

Dimensions
1/2" x 2 1/4"

PIN



Stock Code
MP713
(1382973)

Dimensions
3/16" x 3 1/4" x 16'

PFJ

MSP713
(1567351)
MSP71308
(1567352)

3/16" x 3 1/4"
1/2" x 3 1/4" x 8'

PIN

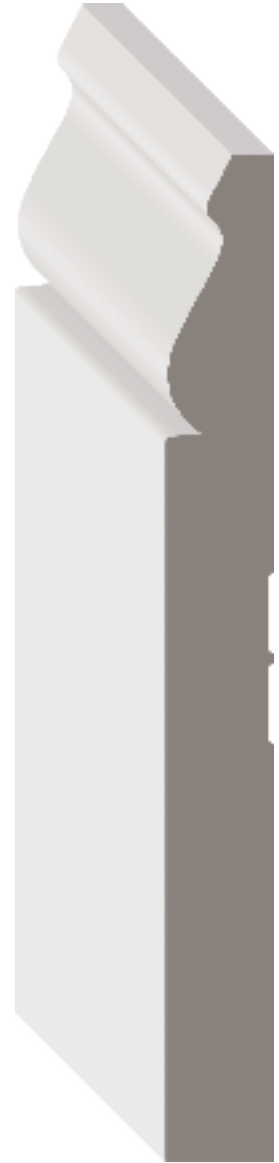

Stock Code
MP639
(1567181)

Dimensions
1/2" x 3 1/4" x 16'

MP641
(1382551)

3/16" x 5 1/4" x 16'

PFJ

BASEBOARDS



Stock Code
MFPU8281
 (1626223)
1677449

Dimensions
 $\frac{1}{2}$ " x 6" x 16'
 $\frac{1}{2}$ " x 5" x 16'

MDF/UL



Stock Code
MAK430
 (1566812)
MAK430FJ
 (1566813)

Dimensions
 $\frac{9}{16}$ " x 4 $\frac{1}{2}$ "
 $\frac{9}{16}$ " x 4 $\frac{1}{2}$ " x 16'

ALD

MFP3112
 (1009326)
MFP613
 (1566982)

$\frac{1}{2}$ " x 3 $\frac{1}{4}$ " x 16'
 $\frac{1}{2}$ " x 4" x 16'

MDF/UL



Stock Code
MAK603
 (1009884)
MAK603FJ
 (1566824)

Dimensions
 $\frac{5}{8}$ " x 5 $\frac{1}{4}$ "
 $\frac{5}{8}$ " x 5 $\frac{1}{4}$ " x 16'

ALD

MH423
 (1007109)

$\frac{1}{2}$ " x 5 $\frac{1}{4}$ "

H

MFP603
 (1566978)
MFP514
 (1646046)
434M
 (1521935)

$\frac{7}{16}$ " x 5" x 16'
 $\frac{1}{2}$ " x 5 $\frac{1}{4}$ " x 16'
 $\frac{1}{2}$ " x 7 $\frac{1}{4}$ " x 16'

MDF/UL

BASEBOARDS



Stock Code
MFP744
(1567000)

Dimensions
 $\frac{3}{16}$ " X $3\frac{3}{16}$ " X 16'

MDF/UL



Stock Code
MAKTABOR4
(1566850)

Dimensions
 $1\frac{1}{16}$ " X $4\frac{3}{4}$ "

ALD

MFPTABOR4 $\frac{3}{16}$ " X $4\frac{3}{4}$ " X 16'
(1567033)

MDF/UL



Stock Code
MDFM286
(1566857)

Dimensions
 $\frac{3}{16}$ " X $5\frac{1}{4}$ " X 16'

MDF/UL



Stock Code
MAKTABOR7
(1566851)

Dimensions
 $1\frac{1}{16}$ " X 7"

ALD

MFPTABOR7 $\frac{3}{16}$ " X 7" X 16'
(1567034)

MDF/UL

BASEBOARDS



Stock Code
MAK6777
 (1566829)

Dimensions
 $\frac{5}{8}$ " x $5\frac{1}{4}$ "

ALD

Stock Code
MH6777
 (1006363)

Dimensions
 $\frac{5}{8}$ " x $5\frac{1}{4}$ "

H

Stock Code
MFP6777
 (1566991)

Dimensions
 $\frac{9}{16}$ " x $5\frac{3}{4}$ " x 16'

MDF/UL



Stock Code
MFP161
 (1555868)

Dimensions
 $\frac{9}{16}$ " x $5\frac{1}{4}$ " x 16'

MDF/UL

Stock Code
MFP163
 (1555869)

Dimensions
 $\frac{9}{16}$ " x $7\frac{1}{4}$ " x 16'

MDF/UL



Stock Code
MFP609
 (1566981)

Dimensions
 $\frac{9}{16}$ " x $5\frac{3}{4}$ " x 16'

MDF/UL

Stock Code
MFP338
 (1566913)

Dimensions
 $\frac{9}{16}$ " x $7\frac{7}{8}$ " x 16'

MDF/UL

BASEBOARDS



Stock Code
MH852
(1567088)

Dimensions
 $\frac{1}{2}'' \times 3\frac{1}{4}''$

H

MFP852
(1567014)

$\frac{1}{2}'' \times 3\frac{3}{16}'' \times 16'$

MDF/UL

MP852
(1567190)

$\frac{5}{8}'' \times 3\frac{1}{4}'' \times 16'$

PFJ



Stock Code
MH952
(1006774)

Dimensions
 $\frac{1}{2}'' \times 4\frac{1}{2}''$

H

MFP952
(1567021)

$\frac{1}{2}'' \times 4\frac{5}{16}'' \times 16'$

MDF/UL

MP952
(1567196)

$\frac{1}{2}'' \times 4\frac{5}{16}'' \times 16'$

PFJ



Stock Code
MFP822
(1567008)

Dimensions
 $\frac{9}{16}'' \times 3\frac{3}{4}'' \times 16'$

MDF/UL



Stock Code
MP522V
(1567174)

Dimensions
 $\frac{9}{16}'' \times 4\frac{1}{2}'' \times 16'$

PFJ

BASEBOARDS



Stock Code
MFP683
(1010070)

Dimensions
 $\frac{9}{16}$ " x $3\frac{1}{4}$ " x 16'

MDF/UL

MP683
(1567183)

$\frac{9}{16}$ " x $3\frac{1}{4}$ " x 16'

PFJ



Stock Code
MFP684
(1050357)

Dimensions
 $\frac{9}{16}$ " x $5\frac{3}{16}$ " x 16'

MDF/UL

MP684
(1567185)

$\frac{9}{16}$ " x $5\frac{3}{16}$ " x 16'

PFJ



Stock Code
MAK412
(1566808)

Dimensions
 $\frac{5}{8}$ " x $4\frac{1}{2}$ "

ALD

MFP412M
(1566943)

$\frac{1}{2}$ " x $4\frac{1}{4}$ " x 16'

MDF/UL

BASEBOARDS



Stock Code
MFP412U
(1328503)

Dimensions
 $\frac{3}{16}$ " x 4 $\frac{1}{4}$ " x 16'

MDF/UL



Stock Code
MFP414U
(1566948)

Dimensions
 $\frac{3}{16}$ " x 5 $\frac{1}{4}$ " x 16'

MDF/UL



Stock Code
MFP746
(1567002)

Dimensions
 $\frac{3}{16}$ " x 5 $\frac{1}{4}$ " x 16'

MDF/UL

BASEBOARDS



Stock Code
MH618
(1556168)

Dimensions
 $\frac{1}{2}$ " x $5\frac{1}{4}$ "

H

MFP618
(1328523)

$\frac{1}{2}$ " x $5\frac{1}{4}$ " x 16'

MDF/UL

MP618
(1556324)

$\frac{3}{16}$ " x $5\frac{3}{16}$ " x 16'

PFJ

MSP618
(1382931)

$\frac{3}{16}$ " x $5\frac{1}{4}$ "

PIN



Stock Code
MFP620
(1046119)

Dimensions
 $\frac{1}{2}$ " x $4\frac{1}{4}$ " x 16'

MDF/UL



Stock Code
MH623V
(1567083)

Dimensions
 $\frac{1}{2}$ " x $3\frac{1}{4}$ "

H

MFP623
(1566985)

$\frac{1}{2}$ " x $3\frac{1}{4}$ " x 16'

MDF/UL

MP633
(1567179)

$\frac{1}{2}$ " x $3\frac{3}{16}$ " x 16'

PFJ

MSP633
(1567348)

$\frac{1}{2}$ " x $3\frac{3}{16}$ "

PIN



Stock Code
MFP634
(1066924)

Dimensions
 $\frac{1}{2}$ " x $2\frac{1}{2}$ " x 16'

MDF/UL

MSP634V
(1567350)

$\frac{1}{2}$ " x $2\frac{1}{2}$ "

PIN

BASEBOARDS



Stock Code
MFP8243
(1555939)

Dimensions
1/2" x 4 1/4" x 16'

MDF/UL



Stock Code
MH811
(1567087)

Dimensions
5/8" x 4 7/16"

H

MFP811
(1567007)

3/16" x 4 7/16" x 16'

MDF/UL

MP811
(1567189)

3/16" x 4 7/16" x 16'

PFJ



Stock Code
MFP8234
(1555938)

Dimensions
3/16" x 5 1/2" x 16'

MDF/UL



Stock Code
MFP207
(1002010)

Dimensions
3/16" x 7 1/4" x 16'

MDF/UL

BASEBOARDS



Stock Code
MH711
(1567085)

Dimensions
 $\frac{1}{2}'' \times 3\frac{1}{4}''$

H

MFP711
(1566996)

$\frac{1}{2}'' \times 3\frac{1}{4}'' \times 16'$

MDF/UL

MP711
(1567186)

$\frac{1}{2}'' \times 3\frac{1}{4}'' \times 16'$

PFJ



Stock Code
MFP545
(1341818)

Dimensions
 $\frac{9}{16}'' \times 5'' \times 16'$

MDF/UL



Stock Code
1324433
1324436

Dimensions
 $\frac{3}{4}'' \times 5\frac{1}{2}'' \times 16'$
 $\frac{3}{4}'' \times 7\frac{1}{4}'' \times 16'$
MDF/UL

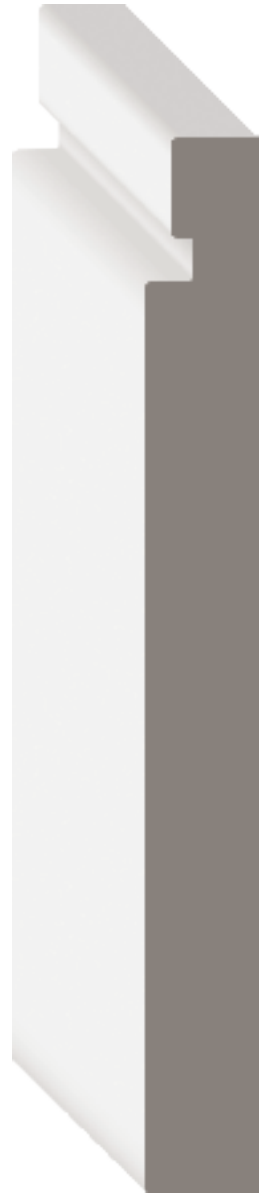

Stock Code
1323956

Dimensions
 $\frac{9}{16}'' \times 5\frac{1}{2}'' \times 16'$
MDF/UL

BASEBOARD CAPS & SHOES

Baseboard caps are added to the top of regular baseboard moulding and flush to the wall to create a finished and more complex architectural moulding. Baseboard shoes are primarily used to trim flooring materials and are often used in combination with a traditional baseboard to conceal variations between the flooring and the base. However, this versatile profile works great to solve numerous trimming needs.



Stock Code
MSP163
(1461926)

Dimensions
1 1/16" x 1 3/8"

PIN



Stock Code
MSPPM5
(1567375)

Dimensions
5/8" x 1 1/16"

PIN



Stock Code
MP126
(1382473)

Dimensions
1/2" x 3/4" x 16'

PFJ

MSP126
(1461861)

1/2" x 3/4"

MSP12608
(1567299)

1/2" x 3/4" x 8'

PIN

CASINGS

Casings bring a room together – left to right, top to bottom. And like any framing element, the options are endless, from build-ups of multiple pieces to full wraps. With casings, there's no wrong way, only your way.



Stock Code	Dimensions
MP32707 (1567149)	1¹/₁₆" x 2¹/₄" x 7'
MP32716 (1567150)	1¹/₁₆" x 2¹/₄" x 16'

PFJ

Stock Code	Dimensions
MSP327 (1567334)	1¹/₁₆" x 2¹/₄"
MSP32707 (1567335)	1¹/₁₆" x 2¹/₄" x 7'

PIN



Stock Code	Dimensions
MFP396 (1566936)	5/16" x 3¹/₄" x 16'

MDF/UL



Stock Code	Dimensions
MDFM18617 (1566856)	1¹/₁₆" x 3¹/₂" x 17'

MDF/UL

CASINGS



Stock Code
MH47307
(1567080)

Dimensions
5/8" x 2 1/4" x 7'

H

MFP47307
(1555908)

3/16" x 2 1/4" x 85"

MFP47317
(1566955)

3/16" x 2 1/4" x 17'

MDF/UL

MP473
(1567170)

5/8" x 2 1/4" x 14'

PFJ

MSP473WM
(1567346)

3/16" x 2 1/4"

PIN



Stock Code
MH433
(1006054)

Dimensions
3/16" x 3 1/4"

MH43308
(1567076)

3/16" x 3 1/4" x 8'

H

MP433
(1567164)

1/2" x 3 1/8" x 16'

PFJ

MSP433A
(1567341)

1/2" x 3 1/4"

PIN



Stock Code
MAK413
(1007674)

Dimensions
3/4" x 3 1/4"

MAK41388
(1566811)

3/4" x 3 1/4" x 88"

ALD

MFP413
(1676937)

1 1/16" x 3 1/4" x 17'

MDF/UL

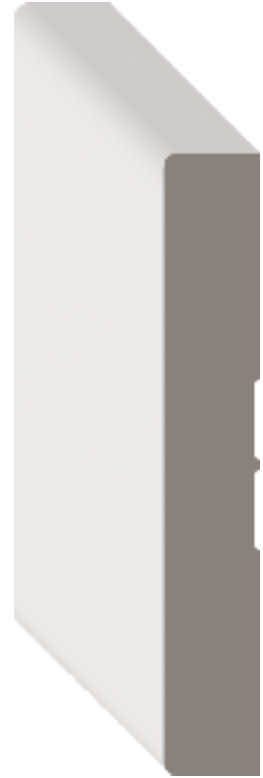

Stock Code
MFP49417
(1566957)

Dimensions
1/2" x 3 1/4" x 17'

WP494
(1680480)

3/16" x 3 1/4" x 17'

MDF/UL



Stock Code
MH356
(1556134)
MH35607
(1556135)

Dimensions
5/8" x 2 1/4"
5/8" x 2 1/4" x 7'

H

MFP35617
(1555894)
MFP35685
(1555895)

1/16" x 2 1/4" x 17'
1/16" x 2 1/4" x 85"

MDF/UL

MP356
(1567156)
MP35607
(1567157)

5/8" x 2 1/4" x 14'
5/8" x 2 1/4" x 7'

PFJ

MSP356
(1567338)
MSP35607
(1567339)

5/8" x 2 1/4"
5/8" x 2 1/4" x 7'

PIN



Stock Code
MH444V
(1009986)

Dimensions
5/8" x 3 1/4"

H

MFP44417
(1566950)

1/16" x 3 1/8" x 17'

MDF/UL

MP444V
(1567166)

1 1/16" x 3 7/16" x 16'

PFJ

MSP444
(1567342)

1 1/16" x 3 7/16"

PIN



Stock Code
MP445
(1382846)

Dimensions
1 1/16" x 3 1/4" x 16'

PFJ



Stock Code
MFP3122
(1555886)

Dimensions
1" x 3 1/2" x 16'

MDF/UL

CASINGS



Stock Code
MFPU8081
 (1626213)
1677196

Dimensions
 $\frac{5}{8}$ " x $3\frac{1}{4}$ " x 16'
 $\frac{5}{8}$ " x $2\frac{3}{4}$ " x 16'

MDF/UL



Stock Code
MFP309
 (1566900)

Dimensions
 $1\frac{1}{16}$ " x $3\frac{1}{4}$ " x 17'

MDF/UL



Stock Code
MAK312
 (1566797)

Dimensions
 $1\frac{1}{16}$ " x 3"

ALD

MFP312M
 (1566906)

$\frac{9}{16}$ " x $2\frac{15}{16}$ " x 17'

MDF/UL



Stock Code
MH346
 (1567064)
MH34607
 (1567065)

Dimensions
 $\frac{5}{8}$ " x $2\frac{3}{16}$ "
 $\frac{5}{8}$ " x $2\frac{3}{16}$ " x 7'

H

MFP346
 (1566915)
MFP34685
 (1064098)

$\frac{9}{16}$ " x $2\frac{1}{4}$ " x 17'
 $\frac{9}{16}$ " x $2\frac{1}{4}$ " x 85"

MDF/UL

MP346
 (1567151)
MP34607
 (1567152)

$\frac{5}{8}$ " x $2\frac{1}{4}$ " x 14'
 $\frac{5}{8}$ " x $2\frac{1}{4}$ " x 7'

PFJ

MSP346
 (1567336)
MSP34607
 (1567337)

$\frac{5}{8}$ " x $2\frac{1}{4}$ "
 $\frac{5}{8}$ " x $2\frac{1}{4}$ " x 7'

PIN



Stock Code
MFP322
(1566911)

Dimensions
 $\frac{9}{16}$ " x 2½" x 17'

MDF/UL



Stock Code
MFP456
(1566953)

Dimensions
 $\frac{9}{16}$ " x 2¼" x 17'

MDF/UL



Stock Code
MFP410U17
(1676406)

Dimensions
1½" x 2¼" x 17'

MDF/UL



Stock Code
MFP411U17
(1566941)

Dimensions
1½" x 3" x 17'

MDF/UL

CASINGS



Stock Code
MFP387
 (1566932)
MFP38785
 (1566933)

Dimensions
 $\frac{5}{8}$ " x 2 $\frac{1}{4}$ " x 17'
 $\frac{5}{8}$ " x 2 $\frac{1}{4}$ " x 85"

MDF/UL

MP387
 (1567158)

$\frac{5}{8}$ " x 2 $\frac{1}{4}$ " x 14'

PFJ



Stock Code
MAK352
 (1566800)

Dimensions
 $1\frac{1}{16}$ " x 2 $\frac{7}{16}$ "

ALD

MH352
 (1003131)

$\frac{5}{8}$ " x 2 $\frac{1}{2}$ "

MH35285
 (1567067)

$\frac{5}{8}$ " x 2 $\frac{1}{2}$ " x 7'

H

MFP352
 (1566917)

$\frac{5}{8}$ " x 2 $\frac{1}{2}$ " x 17'

MFP35285
 (1566918)

$\frac{5}{8}$ " x 2 $\frac{1}{2}$ " x 85"

MDF/UL

MP352
 (1567154)

$\frac{5}{8}$ " x 2 $\frac{1}{2}$ " x 14'

MP35207
 (1567155)

$\frac{5}{8}$ " x 2 $\frac{1}{2}$ " x 7'

PFJ



Stock Code
MAKTABOR3
 (1566849)

Dimensions
 $1\frac{3}{16}$ " x 3"

ALD

MFPTABOR3
 (1567032)

$1\frac{1}{16}$ " x 3" x 17'

MDF/UL



Stock Code
MAK3777
 (1566804)

Dimensions
 $1\frac{1}{16}$ " x 3 $\frac{1}{4}$ "

ALD

MH3777
 (1010462)

$1\frac{1}{16}$ " x 3 $\frac{1}{4}$ "

H

MFP3777
 (1566928)

$1\frac{1}{16}$ " x 3 $\frac{1}{4}$ " x 17'

MDF/UL



Stock Code Dimensions
MH311 $\frac{9}{16}'' \times 2\frac{7}{16}''$
 (1008887)
MH31185 $\frac{9}{16}'' \times 2\frac{7}{16}'' \times 7'$
 (1567060)

H

.....
MFP311 $\frac{9}{16}'' \times 2\frac{7}{16}'' \times 17'$
 (1566901)
MFP31185 $\frac{9}{16}'' \times 2\frac{7}{16}'' \times 85''$
 (1566902)

MDF/UL

.....
MP311 $\frac{5}{8}'' \times 2\frac{7}{16}'' \times 14'$
 (1567142)

PFJ



Stock Code Dimensions
MH411 $1\frac{1}{16}'' \times 3\frac{3}{4}''$
 (1009360)

H

.....
MFP411 $\frac{9}{16}'' \times 3\frac{3}{4}'' \times 17'$
 (1566939)

MDF/UL

.....
MP411 $1\frac{1}{16}'' \times 3\frac{3}{4}'' \times 17'$
 (1567161)

PFJ



Stock Code Dimensions
1675700 $1'' \times 3\frac{1}{2}'' \times 16'$
MDF/UL

CASINGS



Stock Code
MFP8233
(1046142)

Dimensions
9/16" x 3 3/4" x 16'

MDF/UL



Stock Code
MFP00317
(1566860)

Dimensions
1 1/16" x 3 3/4" x 17'

MDF/UL



Stock Code
MFP53517
(1566973)

Dimensions
1 1/16" x 3 1/2" x 17'

MDF/UL



Stock Code
1390847

Dimensions
3/4" x 3 1/2" x 16'
MDF/UL

CORNER GUARDS

CORNER GUARDS

Corner guards are used to protect the outside edges of the wall from damage and abrasion. Corner guards come in a wide variety of sizes and detailing.



Stock Code
MSP20608
(1567316)

Dimensions
1 1/16" x 1 1/16" x 8'

PIN



Stock Code
MSP20508
(1510329)

Dimensions
1 1/16" x 1 1/16" x 8'

PIN



Stock Code
MSP20408
(1567314)

Dimensions
1/4" x 1 1/4" x 8'

PIN

CROWNS

CROWNS

Cap off your look with the perfect crown.
A great crown is the royal wrap-up
of all your moulding decisions.

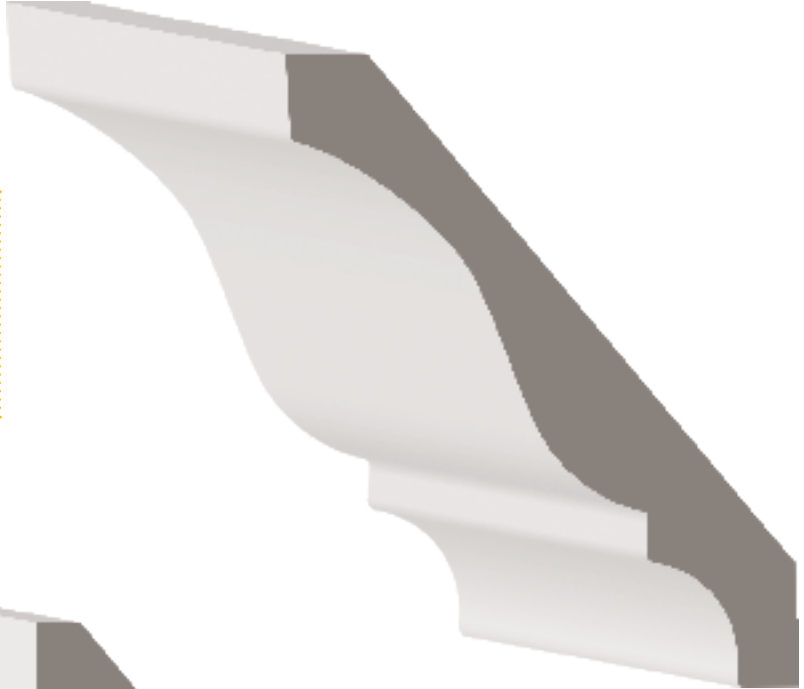

Stock Code
MAK548
(1566819)

Dimensions
 $\frac{5}{8}'' \times 4\frac{1}{8}''$

ALD

MFP047
(1626166)

$\frac{5}{8}'' \times 4\frac{1}{4}'' \times 16'$

MDF/UL

MP047
(1382874)

$\frac{3}{16}'' \times 4\frac{3}{16}'' \times 16'$

PFJ

MSP047
(1382872)

$\frac{3}{16}'' \times 4\frac{3}{16}''$

PIN



Stock Code
MH049
(1556005)

Dimensions
 $\frac{1}{2}'' \times 3\frac{3}{16}''$

H

MFP049
(1566867)

$\frac{3}{16}'' \times 3\frac{3}{16}'' \times 16'$

MDF/UL

MP049
(1567113)

$\frac{1}{2}'' \times 3\frac{5}{8}'' \times 16'$

PFJ

MSP049
(1382883)

$\frac{1}{2}'' \times 3\frac{3}{16}''$

PIN



Stock Code
MSP052V
(1382904)

Dimensions
 $\frac{3}{16}'' \times 2\frac{5}{8}''$

PIN

CROWNS

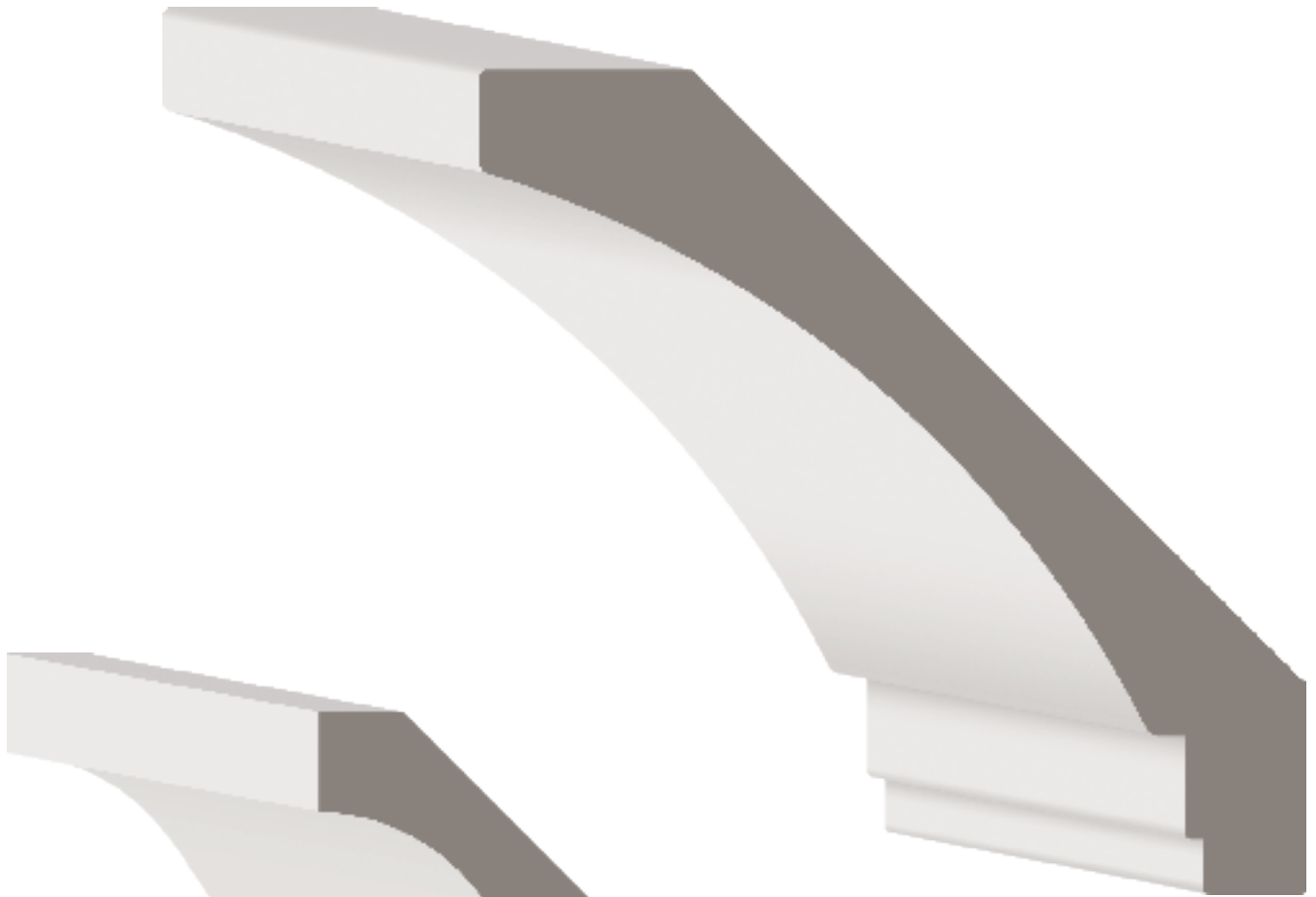

Stock Code
1326328

Dimensions
1 1/4" x 6 1/4" x 16'
MDF/UL



Stock Code
MFP045
(1448078)

Dimensions
3/16" x 5 1/4" x 16'
MDF/UL

CROWNS



Stock Code
MP550
(1556322)

Dimensions
1 1/8" x 5 7/16" x 16'

PFJ

Stock Code
MFP043
(1555825)

Dimensions
1" x 6 15/16" x 16'

MDF/UL

CROWNS

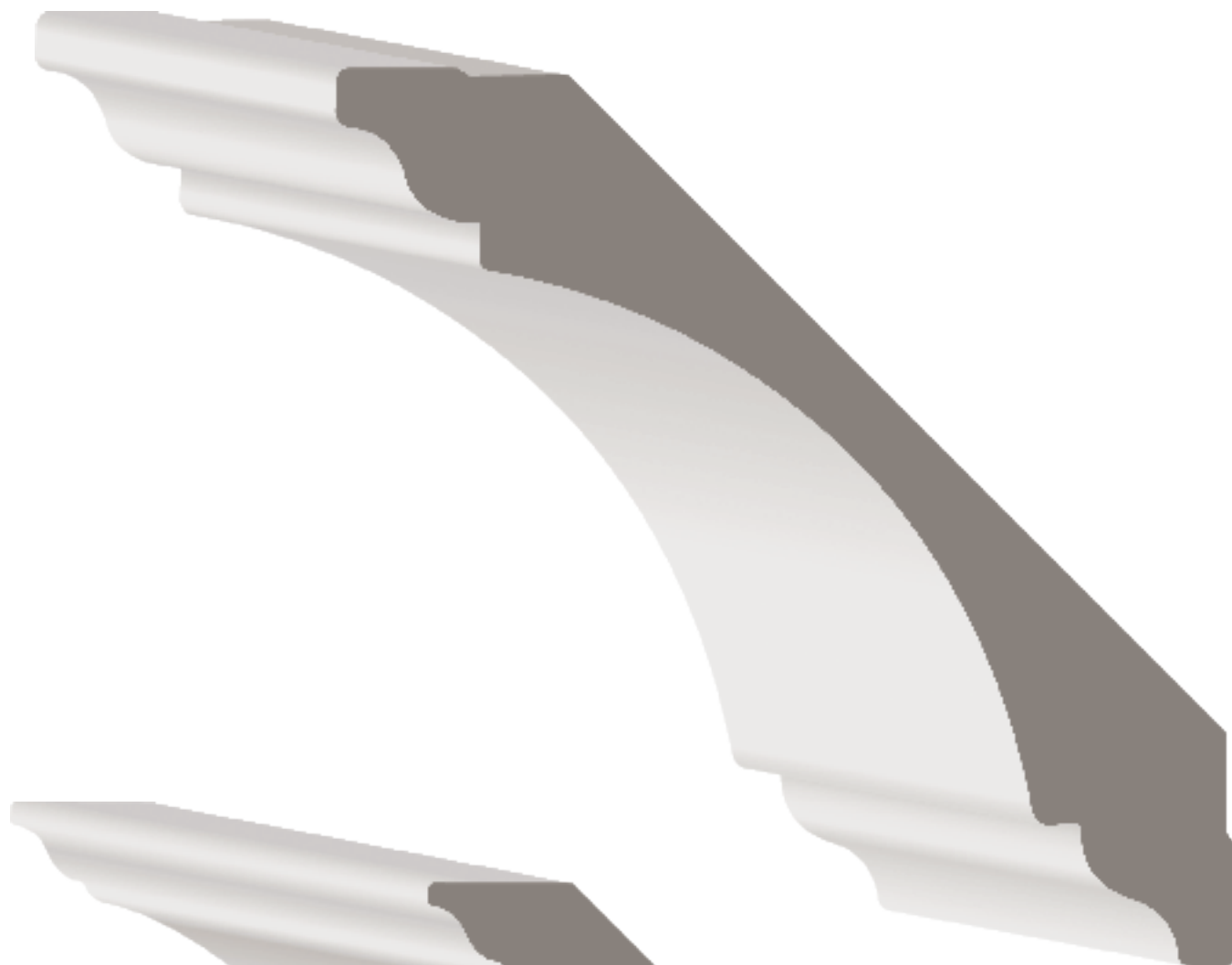

Stock Code
MFP041
(1626152)

Dimensions
1³/₁₆" x 6⁵/₁₆" x 16'

MDF/UL



Stock Code
MFP040
(1328500)

Dimensions
1¹/₁₆" x 4¹/₄" x 16'

MDF/UL

DOOR STOPS

DOOR STOPS

The door stop mouldings are attached to the door jamb on both sides and at the top. It is where the door comes to a rest when it is closed, stopping the door from moving any further, and covering the gap that would otherwise appear between the door and the jambs.

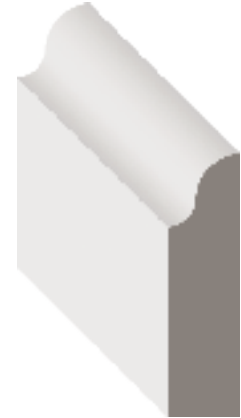

Stock Code
MSP85707
(1567355)

Dimensions
 $\frac{3}{8}$ " x $1\frac{1}{4}$ " x 7'

PIN



Stock Code
MAK876
(1566833)

Dimensions
 $\frac{7}{16}$ " x $1\frac{3}{8}$ "

ALD

MH866
(1010933)

$\frac{7}{16}$ " x $1\frac{5}{16}$ "

MH86607
(1556190)

$\frac{7}{16}$ " x $1\frac{5}{16}$ " x 7'

H

MP886
(1567191)

$\frac{3}{8}$ " x $1\frac{5}{16}$ " x 17'

MP88607
(1567192)

$\frac{3}{8}$ " x $1\frac{5}{16}$ " x 7'

PFJ

MSP87607
(1567357)

$\frac{7}{16}$ " x $1\frac{3}{8}$ " x 7'

MSP87699
(1567358)

$\frac{7}{16}$ " x $1\frac{3}{8}$ " x 99"

PIN

Stock Code
MAK916
(1566834)

Dimensions
 $\frac{3}{8}$ " x $1\frac{3}{8}$ "

ALD

MH916
(1567094)

$\frac{3}{8}$ " x $1\frac{3}{8}$ "

MH91607
(1567095)

$\frac{3}{8}$ " x $1\frac{3}{8}$ " x 7'

H

MR091607
(1567280)

$\frac{3}{8}$ " x $1\frac{3}{8}$ " x 7'

O

MP916
(1567194)

$\frac{3}{8}$ " x $1\frac{3}{8}$ " x 17'

MP91607
(1567195)

$\frac{3}{8}$ " x $1\frac{3}{8}$ " x 7'

PFJ

MSP91607
(1567362)

$\frac{3}{8}$ " x $1\frac{3}{8}$ " x 7'

PIN

FLAT STOCK

Finished boards come in either S4S (Surfaced 4 Sides) or S3S (Surfaced 3 Sides) and are used for a multitude of purposes, including shelving, window ledges, base, casing, etc.

Stock Code	Thickness	Height	Length	Species	Description
MFP248 (1566894)	11/16"	1-3/4"	16'	MDF/UL	Eased 2 Edges
MFP246 (1566892)	11/16"	2-3/4"	16'	MDF/UL	Eased 2 Edges
MFP104 (1555846)	11/16"	3-1/2"	16'	MDF/UL	Eased 2 Edges
MFP10417 (1566874)	11/16"	3-1/2"	17'	MDF/UL	Eased 2 Edges
MFP106 (1555852)	11/16"	5-1/2"	16'	MDF/UL	Eased 2 Edges
MFP108 (1555857)	11/16"	7-1/4"	16'	MDF/UL	Eased 2 Edges
MFP110 (1555861)	11/16"	9-1/4"	16'	MDF/UL	Eased 2 Edges
MFP112 (1555864)	11/16"	11-1/4"	16'	MDF/UL	Eased 2 Edges
MFP5/44 (1555913)	1"	3-1/2"	16'	MDF/UL	Eased 2 Edges
MFP5/46 (1545343)	1"	5-1/2"	16'	MDF/UL	Eased 2 Edges
MFP5/48 (1555916)	1"	7-1/4"	16'	MDF/UL	Eased 2 Edges
LHVG248 (1002047)	11/16"	1-3/4"	RL	H	Eased 4 Edges
LHVG246 (1002315)	11/16"	2-3/4"	RL	H	Eased 4 Edges
LHVG104 (1625888)	11/16"	3-1/2"	RL	H	Eased 4 Edges
LHVG106 (1555608)	11/16"	5-1/2"	RL	H	Eased 4 Edges
LHVG108 (1625891)	11/16"	7-1/4"	RL	H	Eased 4 Edges
LHVG110 (1555619)	11/16"	9-1/4"	RL	H	Eased 4 Edges
LHVG112 (1555620)	11/16"	11-1/4"	RL	H	Eased 4 Edges
LHVG546 (1002280)	1"	5-1/2"	RL	H	Eased 4 Edges
MSP254 (1567320)	1/2"	3/4"	RL	PIN	Moulding
MSP25408 (1484627)	1/2"	3/4"	8'	PIN	Moulding
MSP23908 (1567319)	3/4"	3/4"	8'	PIN	Square
LAK248 (1577585)	3/4"	1-3/4"	RL	ALD	Square Edges
LAK104SQ (1566728)	3/4"	3-1/2"	RL	ALD	Square Edges
LAK104SQFJ (1566729)	3/4"	3-1/2"	16'	ALD	Square Edges
LAK106SQ (1011331)	3/4"	5-1/2"	RL	ALD	Square Edges
LAK106SQFJ (1566732)	3/4"	5-1/2"	16'	ALD	Square Edges

Stock Code	Thickness	Height	Length	Species	Description
LAK108SQ (1566734)	3/4"	7-1/4"	RL	ALD	Square Edges
LAK108SQFJ (1566735)	3/4"	7-1/4"	16'	ALD	Square Edges
LAK110SQ (1566737)	3/4"	9-1/4"	RL	ALD	Square Edges
LAK112SQ (1566739)	3/4"	11-1/4"	RL	ALD	Square Edges
LAK546V (1566742)	1"	5-1/2"	RL	ALD	Square Edges
LAS10271 (1566743)	3/4"	1-3/4"	RL	ALD	Square Edges
LAS104 (1566744)	3/4"	3-1/2"	RL	ALD	Square Edges
LAS106 (1566745)	3/4"	5-1/2"	RL	ALD	Square Edges
LAS108 (1566746)	3/4"	7-1/4"	RL	ALD	Square Edges
LAS11271 (1566748)	3/4"	11-1/4"	RL	ALD	Square Edges
LPOP248 (1566778)	3/4"	1-3/4"	RL	POP	Square Edges
LPOP104 (1625930)	3/4"	3-1/2"	RL	POP	Square Edges
LPOP106 (1625932)	23/32"	5-1/2"	RL	POP	Square Edges
LPOP108 (1625933)	23/32"	7-1/4"	RL	POP	Square Edges
LPOP110 (1484185)	3/4"	9-1/4"	RL	POP	Square Edges
LPOP112 (1484231)	3/4"	11-1/4"	RL	POP	Square Edges
LRFJ248 (1566780)	11/16"	1-3/4"	16'	FJR	Square Edges
LRFJ246 (1566779)	11/16"	2-3/4"	16'	FJR	Square Edges
LR0248 (1566786)	3/4"	1-3/4"	RL	O	Square Edges
LR0104 (1328175)	3/4"	3-1/2"	RL	O	Square Edges
LR0106 (1328185)	3/4"	5-1/2"	RL	O	Square Edges
LR0108 (1625967)	3/4"	7-1/4"	RL	O	Square Edges
LR0112 (1002008)	3/4"	11-1/4"	RL	O	Square Edges
LSP248 (1566788)	21/32"	1-3/4"	RL	PIN	Square Edges
LSP246 (1566787)	11/16"	2-3/4"	RL	PIN	Square Edges
MFP248SQ (1566895)	11/16"	1-3/4"	16'	MDF/UL	Square Edges
MFP246SQ (1566893)	11/16"	2-3/4"	16'	MDF/UL	Square Edges
MFP104SQ (1566875)	11/16"	3-1/2"	16'	MDF/UL	Square Edges
MFP106SQ (1577649)	11/16"	5-1/2"	16'	MDF/UL	Square Edges
MFP108SQ (1005603)	11/16"	7-1/4"	16'	MDF/UL	Square Edges
MFP110SQ (1521204)	11/16"	9-1/4"	16'	MDF/UL	Square Edges
MFP112SQ (1566884)	11/16"	11-1/4"	16'	MDF/UL	Square Edges
MP248 (1382681)	21/32"	1-3/4"	16'	PFJ	Square Edges
MP246 (1567140)	21/32"	2-3/4"	16'	PFJ	Square Edges
MP104SQ (1567120)	21/32"	3-1/2"	16'	PFJ	Square Edges
MP106SQT (1394311)	21/32"	5-1/2"	16'	PFJ	Square Edges
MP108SQT (1394347)	21/32"	7-1/4"	16'	PFJ	Square Edges

JAMBS

JAMBS

The top and two sides of a door or window frame that contact the door or sash: top jamb and side jambs. The most common size for interior use is 11/16" thick by 4-9/16" wide.

Stock Code	Thickness	Width	Length	Species
JRFJ458F (1566687)	11/16"	4-5/8"	82-3/16"	FJR
JRFJ458F9712 (1566689)	11/16"	4-5/8"	98-3/16"	FJR
JRFJ658F (1566704)	11/16"	6-5/8"	82-3/16"	FJR
JRFJ658F9712 (1566708)	11/16"	6-5/8"	98-3/16"	FJR
MAKJ413F9712 (1588377)	11/16"	4-13/16"	98-3/16"	ALD
MAKJ458F (1566838)	11/16"	4-5/8"	82-3/16"	ALD
MAKJ458F9712 (1009803)	11/16"	4-5/8"	98-3/16"	ALD
MAKJ458K99 (1566841)	1-3/16"	4-5/8"	100-3/16"	ALD
MAKJ658F (1566842)	11/16"	6-5/8"	82-3/16"	ALD
MAKJ658F9712 (1566843)	11/16"	6-5/8"	98-3/16"	ALD
MAKJ658K (1566844)	1-7/32"	6-5/8"	82-1/2"	ALD
MAKJ658K99V (1566846)	1-7/32"	6-5/8"	100-3/16"	ALD
MFPJ458F (1567028)	11/16"	4-5/8"	82-3/16"	MDF/UL
1683037	11/16"	4-5/8"	98-3/16"	MDF/UL
MFPJ413F (1567026)	11/16"	4-13/16"	82-3/16"	MDF/UL
MHJ458F9712-VEN (1567100)	11/16"	4-5/8"	98-3/16"	H
MHJ458F-VEN (1567102)	11/16"	4-5/8"	82-3/16"	H
MHJ658F9712-VEN (1009550)	11/16"	6-5/8"	98-3/16"	H
MHJ658K (1676282)	1-7/32"	6-5/8"	83-1/2"	H
MHJ658K9812 (1668167)	1-7/32"	6-5/8"	99-3/4"	H
MPJ458F (1567202)	11/16"	4-5/8"	82-3/16"	PFJ
MPJ458F9712 (1567204)	11/16"	4-5/8"	98-3/16"	PFJ
MPJ458K (1567206)	1-7/32"	4-5/8"	83-1/2"	PFJ
MPJ458K99 (1567207)	1-7/32"	4-5/8"	99-3/4"	PFJ
MPJ413F (1556341)	11/16"	4-13/16"	82-3/16"	PFJ
MPJ413F9712 (1567199)	11/16"	4-13/16"	98-3/16"	PFJ
MPJ413K (1556345)	1-7/32"	4-13/16"	83-1/2"	PFJ
MPJ514F (1567215)	11/16"	5-1/4"	82-3/16"	PFJ
MPJ514K (1567216)	1-7/32"	5-1/4"	83-1/2"	PFJ



Stock Code	Thickness	Width	Length	Species
MPJ658F (1567217)	11/16"	6-5/8"	82-3/16"	PFJ
MPJ658F9712 (1567218)	11/16"	6-5/8"	98-3/16"	PFJ
MPJ658K (1567219)	1-7/32"	6-5/8"	83-1/2"	PFJ
MPJ658K99 (1567220)	1-7/32"	6-5/8"	99-3/4"	PFJ
MPJ714K (1567227)	1-7/32"	7-1/4"	83-1/2"	PFJ
MPJ714K99 (1567228)	1-7/32"	7-1/4"	99-3/4"	PFJ
MROJ458F-VEN (1567281)	11/16"	4-5/8"	82-3/16"	O
MSPJ458F-VEN (1567369)	11/16"	4-5/8"	82-3/16"	PIN
MSPJ458K9812 (1567371)	1-7/32"	4-5/8"	99-3/4"	PIN
MSPJ658K (1567372)	1-7/32"	6-5/8"	83-1/2"	PIN
MSPJ658K9812 (1567373)	1-7/32"	6-5/8"	99-3/4"	PIN

BED MOULD

Similar to crown moulding, used to cover the joint between the ceiling and wall. Can be either sprung or plain, or flush to the wall as an extension of a cornice mould.

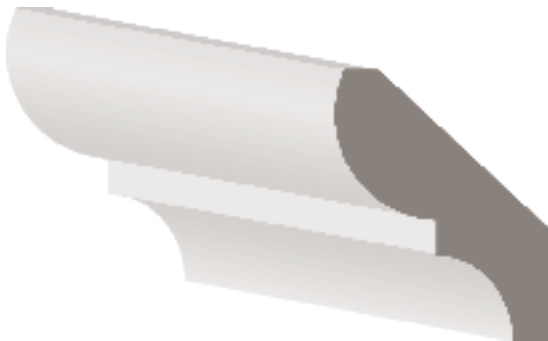

Stock Code
MSP074
(1405323)

Dimensions
 $\frac{9}{16}$ " x $1\frac{3}{4}$ "

PIN

BRICK MOULDS

A brick mould is mainly used as exterior casing around doors. The most common size is 2"; however, 1 1/2" and 1 1/4" sizes are available. Brick moulds can also be used in place of a crown and as a transition under window sills.



Stock Code
MAK180
(1566794)

Dimensions
 $1\frac{1}{4}$ " x 2"

ALD

MH180 $1\frac{3}{16}$ " x $1\frac{15}{16}$ "
(1556025)

MH18007 $1\frac{3}{16}$ " x $1\frac{15}{16}$ " x 7'
(1556026)

H

MP180V $1\frac{1}{4}$ " x 2" x 17'
(1382605)

MP180V07 $1\frac{1}{4}$ " x 2" x 7'
(1567131)

MP180V100 $1\frac{1}{4}$ " x 2" x 100"
(1567134)

PFJ

MSP180V $1\frac{1}{4}$ " x 2"
(1567312)

MSP180V07 $1\frac{1}{4}$ " x 2" x 7'
(1567313)

PIN

CHAMFER STRIP

Utilized where kitchen cabinet tops meet the walls or as a linoleum cove. Sometimes used for window applications.



Stock Code
MSP995
(1416339)

Dimensions
 $\frac{3}{4}$ " x $\frac{3}{4}$ "

PIN

MISCELLANEOUS

CHAIR RAILS

The chair rail runs along the wall, parallel with the baseboard. Adding a refined decor to any space, it's the subtle choice that makes a big impact. The chair rail perfectly complements a wainscot design.



Stock Code
MFP297
(1555876)

Dimensions
1 1/16" x 3" x 16'

MDF/UL

MSP298
(1567331)

5/8" x 2 1/16"

PIN

DECORATIVE MOULDS

A strip of material with various profiles used to cover transitions between surfaces or for decoration.

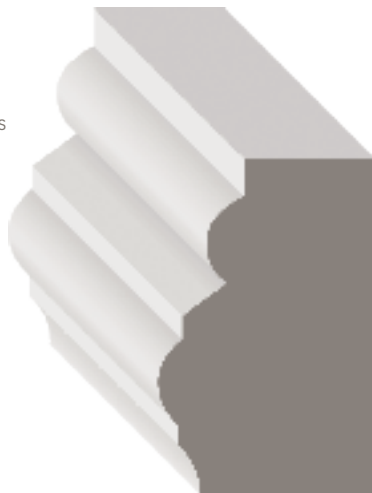

Stock Code
MSP287LWM
(1567328)

Dimensions
1 1/8" x 1 3/4"

PIN

COVES

Coves are commonly used to soften the transition on inside corners but may be used for a wide range of applications.



Stock Code
MP10108
(1567118)

Dimensions
7/16" x 7/16" x 8'

PFJ

MSP093
(1567289)

1 1/16" x 1 1/16"

MSP09308
(1382341)

1 1/16" x 1 1/16" x 8'

PIN

FULL ROUND

Full rounds are used for numerous purposes and projects. Some of the more common uses are closet poles, curtain rods and towel rods.

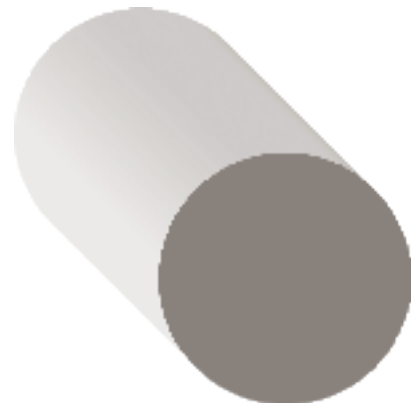

Stock Code
MH233
(1567056)

Dimensions
1 5/16"

H

HANDRAILS

Hand rails provide safety and support.

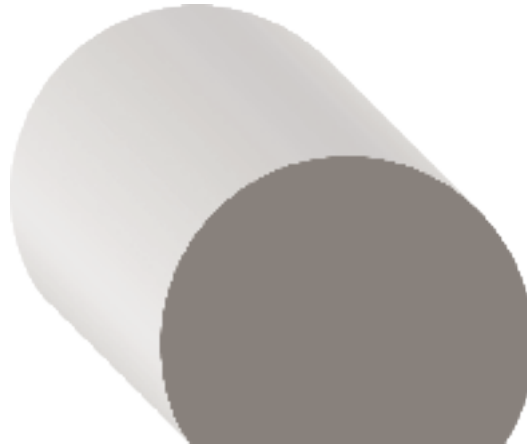

Stock Code	Dimensions
MH1867 (1005608)	1½" x 2"
MH231 (1556034)	1⅞" x 1⅝"

H

GLASS BEAD

Narrow wood strips or moulding used for edging against a door or window sash, or to secure glass panels to doors and windows.



Stock Code	Dimensions
MSP148 (1382508)	¾" x ¾"

PIN



Stock Code	Dimensions
MH206DG (1567053)	1⅞" x 5⅜"

H



Stock Code	Dimensions
MH204NG (1005039)	1⅞" x 3½"
MH206NG (1009639)	1⅞" x 5⅜"

H

MISCELLANEOUS

PANEL & PICTURE MOULDS

The use of panel or picture moulding can be an effective and inexpensive way to frame wall paneling, paper or fabric, and add interest to walls.



Stock Code
MSPDM7
(1567366)

Dimensions
 $1\frac{1}{16}" \times 1\frac{5}{16}"$

PIN



Stock Code
MSPPM1
(1567374)

Dimensions
 $\frac{3}{4}" \times 1\frac{1}{4}"$

PIN



Stock Code
MASPM6
(1566855)

Dimensions
 $1\frac{1}{16}" \times 1\frac{13}{16}"$

ALD



Stock Code
MSPPM6V
(1567377)

Dimensions
 $1\frac{5}{8}" \times 1\frac{13}{16}"$

PIN

LATTICE

A thin strip of flat moulding commonly used to hide seams and edges.



Stock Code
MSP265
(1567322)

Dimensions
 $\frac{1}{4}" \times 1\frac{1}{16}"$

MSP26508
(1484631)

$\frac{1}{4}" \times 1\frac{1}{16}" \times 8'$

MSP267
(1382690)

$\frac{1}{4}" \times 1\frac{3}{8}"$

MSP26708
(1567325)

$\frac{1}{4}" \times 1\frac{3}{8}" \times 8'$

MSP268
(1484635)

$\frac{1}{4}" \times 1\frac{1}{8}"$

MSP26808
(1567327)

$\frac{1}{4}" \times 1\frac{1}{8}" \times 8'$

PIN

QUARTER ROUND

Quarter Rounds come in several sizes and serve a variety of functions. They are most often used with baseboards.



Stock Code **MP105V**
(1567122) Dimensions **3/4" x 3/4" x 16'**

PFJ

MSP105 1 1/16" x 1 1/16"
(1382360)

MSP10508 1 1/16" x 1 1/16" x 8'
(1599514)

MSP108 1/2" x 1/2"
(1484135)

PIN

SCREEN MOULDS

A very versatile profile; screen mould fits a wide variety of needs and uses. Traditionally used to hold mesh screening into wood screens, it also works well as edge trim on various shelving or wood trim for wallpaper.



Stock Code **MSP13708**
(1567305) Dimensions **3/8" x 3/4" x 8'**

PIN

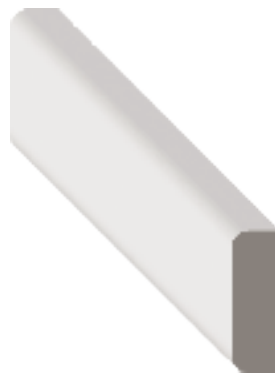

Stock Code **MSP14208**
(1382503) Dimensions **1/4" x 3/4" x 8'**

PIN

SHIPLAPS

A wall paneling treatment made from wide wooden boards installed horizontally to create a rustic, cottage or coastal look.



Stock Code **MFPSHIP6**
(1678870) Dimensions **1/2" x 5 1/2" x 16'**

MFPSHIP8
(1678737) Dimensions **1/2" x 7 1/4" x 16'**

MDF/UL

MISCELLANEOUS

SASH BEADS

Narrow wood strips or moulding used for edging against a door or window sash, or to secure glass panels to doors and windows.

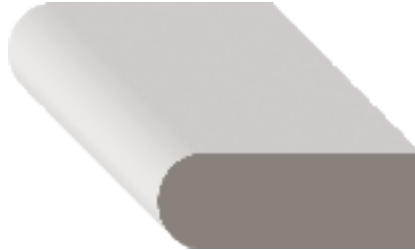

Stock Code	Dimensions
MAK9955 (1008384)	1/2" x 1 1/4"

ALD

MFP953212 (1555947)	7/16" x 1 1/4" x 12'
-------------------------------	----------------------

MDF/UL

SHELVING

Flat boards suitable for a variety of uses, including organizational storage in closets, pantries and more.



Stock Code	Dimensions
SFR11212 (1567399)	1 1/16" x 11 1/4" x 12'
SFR11612 (1567402)	1 1/16" x 15 1/4" x 12'
SFR12412 (1567405)	1 1/16" x 23 1/4" x 12'

MDF/UL

WAINSCOT

Trimwork installed in the area below a chair rail. Numerous options are available including raised panel, shadow box and beaded. Combined with a chair rail and baseboard, wainscoting creates a dramatic look in any room.



Stock Code **MFP222**
(1002119) Dimensions **3/8" x 5 3/4" x 10'**
MDF/UL

WAINSCOT CAP

A wainscot cap is used to finish the top edge of a wainscot wall treatment. It may also be used as one component of a larger chair rail profile.

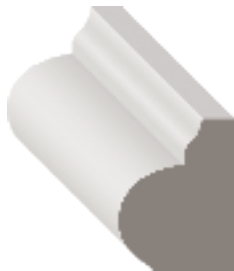

Stock Code **MSP114**
(1393438) Dimensions **5/8" x 1 3/16"**
PIN



Stock Code **MSP29208**
(1567330) Dimensions **9/16" x 1 1/8" x 8'**
PIN



Stock Code **MFP850**
(1626091) Dimensions **1 1/16" x 3 1/4" x 8'**
MDF/UL



Stock Code **MPOPSCM1**
(1567234) Dimensions **1" x 2 1/2"**
POP

INDEX

Stock Code	Profile Type	Dimensions	Species	Page
1323956	Baseboard	9/16" x 5-1/2" x 16'	MDF/UL	17
1324433	Baseboard	3/4" x 5-1/2" x 16'	MDF/UL	17
1324436	Baseboard	3/4" x 7-1/4" x 16'	MDF/UL	17
1326328	Crown	1-1/4" x 6-1/4" x 16'	MDF/UL	29
1390847	Casing	3/4" x 3-1/2" x 16'	MDF/UL	26
1675700	Casing	1" x 3-1/2" x 16'	MDF/UL	25
434M (1521935)	Baseboard	1/2" x 7-1/4" x 16'	MDF/UL	9
JRFJ458F (1566687)	Jamb	11/16" x 4-5/8" x 82-3/16"	FJR	34
JRFJ458F9712 (1566689)	Jamb	11/16" x 4-5/8" x 98-3/16"	FJR	34
JRFJ658F (1566704)	Jamb	11/16" x 6-5/8" x 82-3/16"	FJR	34
JRFJ658F9712 (1566708)	Jamb	11/16" x 6-5/8" x 98-3/16"	FJR	34
LAK248 (1577585)	Flat Stock	3/4" x 1-3/4" x RL	ALD	33
LAK104SQ (1566728)	Flat Stock	3/4" x 3-1/2" x RL	ALD	33
LAK104SQFJ (1566729)	Flat Stock	3/4" x 3-1/2" x 16'	ALD	33
LAK106SQ (1011331)	Flat Stock	3/4" x 5-1/2" x RL	ALD	33
LAK106SQFJ (1566732)	Flat Stock	3/4" x 5-1/2" x 16'	ALD	33
LAK108SQ (1566734)	Flat Stock	3/4" x 7-1/4" x RL	ALD	33
LAK108SQFJ (1566735)	Flat Stock	3/4" x 7-1/4" x 16'	ALD	33
LAK110SQ (1566737)	Flat Stock	3/4" x 9-1/4" x RL	ALD	33
LAK112SQ (1566739)	Flat Stock	3/4" x 11-1/4" x RL	ALD	33
LAK546V (1566742)	Flat Stock	1" x 5-1/2" x RL	ALD	33
LAS10271 (1566743)	Flat Stock	3/4" x 1-3/4" x RL	ALD	33
LAS104 (1566744)	Flat Stock	3/4" x 3-1/2" x RL	ALD	33
LAS106 (1566745)	Flat Stock	3/4" x 5-1/2" x RL	ALD	33
LAS108 (1566746)	Flat Stock	3/4" x 7-1/4" x RL	ALD	33
LAS11271 (1566748)	Flat Stock	3/4" x 11-1/4" x RL	ALD	33
LHVG248 (1002047)	Flat Stock	11/16" x 1-3/4" x RL	H	33
LHVG246 (1002315)	Flat Stock	11/16" x 2-3/4" x RL	H	33
LHVG104 (1625888)	Flat Stock	11/16" x 3-1/2" x RL	H	33
LHVG106 (1555608)	Flat Stock	11/16" x 5-1/2" x RL	H	33
LHVG108 (1625891)	Flat Stock	11/16" x 7-1/4" x RL	H	33
LHVG110 (1555619)	Flat Stock	11/16" x 9-1/4" x RL	H	33
LHVG112 (1555620)	Flat Stock	11/16" x 11-1/4" x RL	H	33
LHVG546 (1002280)	Flat Stock	1" x 5-1/2" x RL	H	33
LPOP248 (1566778)	Flat Stock	3/4" x 1-3/4" x RL	POP	33
LPOP104 (1625930)	Flat Stock	3/4" x 3-1/2" x RL	POP	33
LPOP106 (1625932)	Flat Stock	23/32" x 5-1/2" x RL	POP	33
LPOP108 (1625933)	Flat Stock	23/32" x 7-1/4" x RL	POP	33
LPOP110 (1484185)	Flat Stock	3/4" x 9-1/4" x RL	POP	33
LPOP112 (1484231)	Flat Stock	3/4" x 11-1/4" x RL	POP	33
LRJ248 (1566780)	Flat Stock	11/16" x 1-3/4" x 16'	FJR	33
LRJ246 (1566779)	Flat Stock	11/16" x 2-3/4" x 16'	FJR	33
LR0248 (1566786)	Flat Stock	3/4" x 1-3/4" x RL	O	33
LR0104 (1328175)	Flat Stock	3/4" x 3-1/2" x RL	O	33
LR0106 (1328185)	Flat Stock	3/4" x 5-1/2" x RL	O	33
LR0108 (1625967)	Flat Stock	3/4" x 7-1/4" x RL	O	33
LR0112 (1002008)	Flat Stock	3/4" x 11-1/4" x RL	O	33
LSP248 (1566788)	Flat Stock	21/32" x 1-3/4" x RL	PIN	33
LSP246 (1566787)	Flat Stock	11/16" x 2-3/4" x RL	PIN	33
MAK180 (1566794)	Brick Mould	1-1/4" x 2" x RL	ALD	35
MAK312 (1566797)	Casing	11/16" x 3" x RL	ALD	22

Stock Code	Profile Type	Dimensions	Species	Page
MAK352 (1566800)	Casing	11/16" x 2-7/16" x RL	ALD	24
MAK3777 (1566804)	Casing	11/16" x 3-1/4" x RL	ALD	24
MAK412 (1566808)	Baseboard	5/8" x 4-1/2" x RL	ALD	13
MAK413 (1007674)	Casing	3/4" x 3-1/4" x RL	ALD	20
MAK41388 (1566811)	Casing	3/4" x 3-1/4" x 88"	ALD	20
MAK430 (1566812)	Baseboard	9/16" x 4-1/2" x RL	ALD	9
MAK430FJ (1566813)	Baseboard	9/16" x 4-1/2" x 16'	ALD	9
MAK548 (1566819)	Crown	5/8" x 4-1/8" x RL	ALD	28
MAK603 (1009884)	Baseboard	5/8" x 5-1/4" x RL	ALD	9
MAK603FJ (1566824)	Baseboard	5/8" x 5-1/4" x 16'	ALD	9
MAK6777 (1566829)	Baseboard	5/8" x 5-1/4" x RL	ALD	11
MAK876 (1566833)	Door Stops	7/16" x 1-3/8" x RL	ALD	32
MAK916 (1566834)	Door Stops	3/8" x 1-3/8" x RL	ALD	32
MAK9955 (1008384)	Sash Bead	1/2" x 1-1/4" x RL	ALD	40
MAKJ413F9712 (1588377)	Jamb	11/16" x 4-13/16" x 98-3/16"	ALD	34
MAKJ458F (1566838)	Jamb	3/4" x 4-5/8" x 82-3/16"	ALD	34
MAKJ458F9712 (1009803)	Jamb	3/4" x 4-5/8" x 98-3/16"	ALD	34
MAKJ458K99 (1566841)	Jamb	1-3/16" x 4-5/8" x 100-1/4"	ALD	34
MAKJ658F (1566842)	Jamb	3/4" x 6-5/8" x 82-3/16"	ALD	34
MAKJ658F9712 (1566843)	Jamb	3/4" x 6-5/8" x 98-3/16"	ALD	34
MAKJ658K (1566844)	Jamb	1-7/32" x 6-5/8" x 83-1/2"	ALD	34
MAKJ658K99V (1566846)	Jamb	1-7/32" x 6-5/8" x 100-1/4"	ALD	34
MAKTABOR3 (1566849)	Casing	13/16" x 3" x RL	ALD	24
MAKTABOR4 (1566850)	Baseboard	11/16" x 4-3/4" x RL	ALD	10
MAKTABOR7 (1566851)	Baseboard	11/16" x 7" x RL	ALD	10
MAS130508 (1681998)	Astragal	1-1/4" x 2" x 8'	ALD	7
MASPM6 (1566855)	Panel Mould	1-1/16" x 1-13/16" x RL	ALD	38
MDFM18617 (1566856)	Casing	11/16" x 3-1/2" x 17'	MDF/UL	19
MDFM286 (1566857)	Baseboard	9/16" x 5-1/4" x 16'	MDF/UL	10
MFP00317 (1566860)	Casing	11/16" x 3-1/4" x 17'	MDF/UL	26
MFP040 (1328500)	Crown	11/16" x 4-1/4" x 16'	MDF/UL	31
MFP041 (1626152)	Crown	1-3/16" x 6-5/16" x 16'	MDF/UL	31
MFP043 (1555825)	Crown	1" x 6-15/16" x 16'	MDF/UL	30
MFP045 (1448078)	Crown	9/16" x 5-1/4" x 16'	MDF/UL	29
MFP047 (1626166)	Crown	5/8" x 4-1/4" x 16'	MDF/UL	28
MFP049 (1566867)	Crown	9/16" x 3-9/16" x 16'	MDF/UL	28
MFP104 (1555846)	Flat Stock	11/16" x 3-1/2" x 16'	MDF/UL	33
MFP10417 (1566874)	Flat Stock	11/16" x 3-1/2" x 17'	MDF/UL	33
MFP104SQ (1566875)	Flat Stock	11/16" x 3-1/2" x 16'	MDF/UL	33
MFP106 (1555852)	Flat Stock	11/16" x 5-1/2" x 16'	MDF/UL	33
MFP106SQ (1577649)	Flat Stock	11/16" x 5-1/2" x 16'	MDF/UL	33
MFP108 (1555857)	Flat Stock	11/16" x 7-1/4" x 16'	MDF/UL	33
MFP108SQ (1005603)	Flat Stock	11/16" x 7-1/4" x 16'	MDF/UL	33
MFP110 (1555861)	Flat Stock	11/16" x 9-1/4" x 16'	MDF/UL	33
MFP110SQ (1521204)	Flat Stock	11/16" x 9-1/4" x 16'	MDF/UL	33
MFP112 (1555864)	Flat Stock	11/16" x 11-1/4" x 16'	MDF/UL	33
MFP112SQ (1566884)	Flat Stock	11/16" x 11-1/4" x 16'	MDF/UL	33
MFP161 (1555868)	Baseboard	9/16" x 5-1/4" x 16'	MDF/UL	11
MFP163 (1555869)	Baseboard	9/16" x 7-1/4" x 16'	MDF/UL	11
MFP207 (1002010)	Baseboard	9/16" x 7-1/4" x 16'	MDF/UL	16
MFP222 (1002119)	Wainscot	3/8" x 5-3/4" x 10'	MDF/UL	41

Stock Code	Profile Type	Dimensions	Species	Page
MFP248 (1566894)	Flat Stock	$\frac{11}{16}'' \times 1\text{-}\frac{3}{4}'' \times 16'$	MDF/UL	33
MFP246 (1566892)	Flat Stock	$\frac{11}{16}'' \times 2\text{-}\frac{3}{4}'' \times 16'$	MDF/UL	33
MFP248SQ (1566895)	Flat Stock	$\frac{11}{16}'' \times 1\text{-}\frac{3}{4}'' \times 16'$	MDF/UL	33
MFP246SQ (1566893)	Flat Stock	$\frac{11}{16}'' \times 2\text{-}\frac{3}{4}'' \times 16'$	MDF/UL	33
MFP297 (1555876)	Chair Rail	$\frac{11}{16}'' \times 3'' \times 16'$	MDF/UL	36
MFP309 (1566900)	Casing	$\frac{11}{16}'' \times 3\text{-}\frac{1}{4}'' \times 17'$	MDF/UL	22
MFP311 (1566901)	Casing	$\frac{9}{16}'' \times 2\text{-}\frac{7}{16}'' \times 17'$	MDF/UL	25
MFP3112 (1009326)	Baseboard	$\frac{1}{2}'' \times 3\text{-}\frac{1}{4}'' \times 16'$	MDF/UL	9
MFP31185 (1566902)	Casing	$\frac{9}{16}'' \times 2\text{-}\frac{7}{16}'' \times 7'$	MDF/UL	25
MFP312M (1566906)	Casing	$\frac{9}{16}'' \times 2\text{-}\frac{15}{16}'' \times 17'$	MDF/UL	22
MFP3122 (1555886)	Casing	$1'' \times 3\text{-}\frac{1}{2}'' \times 16'$	MDF/UL	21
MFP322 (1566911)	Casing	$\frac{9}{16}'' \times 2\text{-}\frac{1}{2}'' \times 17'$	MDF/UL	23
MFP338 (1566913)	Baseboard	$\frac{9}{16}'' \times 7\text{-}\frac{7}{8}'' \times 16'$	MDF/UL	11
MFP346 (1566915)	Casing	$\frac{9}{16}'' \times 2\text{-}\frac{1}{4}'' \times 17'$	MDF/UL	22
MFP34685 (1064098)	Casing	$\frac{9}{16}'' \times 2\text{-}\frac{1}{4}'' \times 85''$	MDF/UL	22
MFP352 (1566917)	Casing	$\frac{5}{8}'' \times 2\text{-}\frac{1}{2}'' \times 17'$	MDF/UL	24
MFP35285 (1566918)	Casing	$\frac{5}{8}'' \times 2\text{-}\frac{1}{2}'' \times 85''$	MDF/UL	24
MFP35617 (1555894)	Casing	$\frac{9}{16}'' \times 2\text{-}\frac{1}{4}'' \times 17'$	MDF/UL	21
MFP35685 (1555895)	Casing	$\frac{9}{16}'' \times 2\text{-}\frac{1}{4}'' \times 7'$	MDF/UL	21
MFP3777 (1566928)	Casing	$\frac{11}{16}'' \times 3\text{-}\frac{1}{4}'' \times 17'$	MDF/UL	24
MFP387 (1566932)	Casing	$\frac{5}{8}'' \times 2\text{-}\frac{1}{4}'' \times 17'$	MDF/UL	24
MFP38785 (1566933)	Casing	$\frac{5}{8}'' \times 2\text{-}\frac{1}{4}'' \times 85''$	MDF/UL	24
MFP396 (1566936)	Casing	$\frac{9}{16}'' \times 3\text{-}\frac{1}{4}'' \times 16'$	MDF/UL	19
MFP410U17 (1676406)	Casing	$\frac{11}{16}'' \times 2\text{-}\frac{1}{4}'' \times 17'$	MDF/UL	23
MFP411 (1566939)	Casing	$\frac{9}{16}'' \times 3\text{-}\frac{1}{4}'' \times 17'$	MDF/UL	25
MFP411U17 (1566941)	Casing	$\frac{11}{16}'' \times 3'' \times 17'$	MDF/UL	23
MFP412M (1566943)	Baseboard	$\frac{1}{2}'' \times 4\text{-}\frac{1}{4}'' \times 16'$	MDF/UL	13
MFP412U (1328503)	Baseboard	$\frac{9}{16}'' \times 4\text{-}\frac{1}{4}'' \times 16'$	MDF/UL	14
MFP413 (1676937)	Casing	$\frac{11}{16}'' \times 3\text{-}\frac{1}{4}'' \times 17'$	MDF/UL	20
MFP414U (1566948)	Baseboard	$\frac{9}{16}'' \times 5\text{-}\frac{1}{4}'' \times 16'$	MDF/UL	14
MFP44417 (1566950)	Casing	$\frac{9}{16}'' \times 3\text{-}\frac{1}{8}'' \times 17'$	MDF/UL	21
MFP456 (1566953)	Casing	$\frac{9}{16}'' \times 2\text{-}\frac{1}{4}'' \times 17'$	MDF/UL	23
MFP47307 (1555908)	Casing	$\frac{9}{16}'' \times 2\text{-}\frac{1}{4}'' \times 85''$	MDF/UL	20
MFP47317 (1566955)	Casing	$\frac{9}{16}'' \times 2\text{-}\frac{1}{4}'' \times 17'$	MDF/UL	20
MFP49417 (1566957)	Casing	$\frac{1}{2}'' \times 3\text{-}\frac{1}{4}'' \times 17'$	MDF/UL	20
MFP5/44 (1555913)	Flat Stock	$1'' \times 3\text{-}\frac{1}{2}'' \times 16'$	MDF/UL	33
MFP5/46 (1545343)	Flat Stock	$1'' \times 5\text{-}\frac{1}{2}'' \times 16'$	MDF/UL	33
MFP5/48 (1555916)	Flat Stock	$1'' \times 7\text{-}\frac{1}{4}'' \times 16'$	MDF/UL	33
MFP5000 (1341811)	Architrave	$1\text{-}\frac{3}{16}'' \times 3\text{-}\frac{3}{4}'' \times 16'$	MDF/UL	6
MFP5015 (1677969)	Architrave	$1\text{-}\frac{1}{2}'' \times 5\text{-}\frac{1}{2}'' \times 16'$	MDF/UL	6
MFP5020 (1610429)	Architrave	$1\text{-}\frac{3}{16}'' \times 5\text{-}\frac{1}{4}'' \times 16'$	MDF/UL	6
1324430	Architrave	$1\text{-}\frac{1}{2}'' \times 6\text{-}\frac{1}{2}'' \times 16'$	MDF/UL	6
MFP514 (1646046)	Baseboard	$\frac{1}{2}'' \times 5\text{-}\frac{1}{4}'' \times 16'$	MDF/UL	9
MFP53517 (1566973)	Casing	$\frac{11}{16}'' \times 3\text{-}\frac{1}{2}'' \times 17'$	MDF/UL	26
MFP545 (1341818)	Baseboard	$\frac{9}{16}'' \times 5'' \times 16'$	MDF/UL	17
MFP603 (1566978)	Baseboard	$\frac{7}{16}'' \times 5'' \times 16'$	MDF/UL	9
MFP609 (1566981)	Baseboard	$\frac{9}{16}'' \times 5\text{-}\frac{3}{4}'' \times 16'$	MDF/UL	11
MFP613 (1566982)	Baseboard	$\frac{1}{2}'' \times 4'' \times 16'$	MDF/UL	9
MFP618 (1328523)	Baseboard	$\frac{1}{2}'' \times 5\text{-}\frac{1}{4}'' \times 16'$	MDF/UL	15
MFP620 (1046119)	Baseboard	$\frac{1}{2}'' \times 4\text{-}\frac{1}{4}'' \times 16'$	MDF/UL	15
MFP623 (1566985)	Baseboard	$\frac{1}{2}'' \times 3\text{-}\frac{1}{4}'' \times 16'$	MDF/UL	15

Stock Code	Profile Type	Dimensions	Species	Page
MFP634 (1064924)	Baseboard	$\frac{1}{2}'' \times 2\text{-}\frac{1}{2}'' \times 16'$	MDF/UL	15
MFP6777 (1566991)	Baseboard	$\frac{9}{16}'' \times 5\text{-}\frac{3}{4}'' \times 16'$	MDF/UL	11
MFP683 (1010070)	Baseboard	$\frac{9}{16}'' \times 3\text{-}\frac{1}{4}'' \times 16'$	MDF/UL	13
MFP684 (1050357)	Baseboard	$\frac{9}{16}'' \times 5\text{-}\frac{3}{16}'' \times 16'$	MDF/UL	13
MFP711 (1566996)	Baseboard	$\frac{1}{2}'' \times 3\text{-}\frac{1}{4}'' \times 16'$	MDF/UL	17
MFP744 (1567000)	Baseboard	$\frac{9}{16}'' \times 3\text{-}\frac{3}{16}'' \times 16'$	MDF/UL	10
MFP746 (1567002)	Baseboard	$\frac{9}{16}'' \times 5\text{-}\frac{1}{4}'' \times 16'$	MDF/UL	14
MFP811 (1567007)	Baseboard	$\frac{9}{16}'' \times 4\text{-}\frac{7}{16}'' \times 16'$	MDF/UL	16
MFP822 (1567008)	Baseboard	$\frac{9}{16}'' \times 3\text{-}\frac{1}{4}'' \times 16'$	MDF/UL	12
MFP8233 (1046142)	Casing	$\frac{9}{16}'' \times 3\text{-}\frac{1}{4}'' \times 16'$	MDF/UL	26
MFP8234 (1555938)	Baseboard	$\frac{9}{16}'' \times 5\text{-}\frac{1}{2}'' \times 16'$	MDF/UL	16
MFP8243 (1555939)	Baseboard	$\frac{1}{2}'' \times 4\text{-}\frac{1}{4}'' \times 16'$	MDF/UL	16
MFP850 (1626091)	Wainscot Cap	$1\text{-}\frac{1}{16}'' \times 1\text{-}\frac{3}{4}'' \times 8'$	MDF/UL	41
MFP852 (1567014)	Baseboard	$\frac{1}{2}'' \times 3\text{-}\frac{3}{16}'' \times 16'$	MDF/UL	12
MFP952 (1567021)	Baseboard	$\frac{1}{2}'' \times 4\text{-}\frac{5}{16}'' \times 16'$	MDF/UL	12
MFP953212 (1555947)	Sash Bead	$\frac{7}{16}'' \times 1\text{-}\frac{1}{4}'' \times 12'$	MDF/UL	40
MFPJ413F (1567026)	Jamb	$\frac{11}{16}'' \times 4\text{-}\frac{13}{16}'' \times 82\text{-}\frac{3}{16}''$	MDF/UL	34
MFPJ458F (1567028)	Jamb	$\frac{11}{16}'' \times 4\text{-}\frac{5}{8}'' \times 82\text{-}\frac{3}{16}''$	MDF/UL	34
1683037	Jamb	$\frac{11}{16}'' \times 4\text{-}\frac{5}{8}'' \times 98\text{-}\frac{3}{16}''$	MDF/UL	34
MFPSHIP6 (1678870)	Shiplap	$\frac{1}{2}'' \times 5\text{-}\frac{1}{2}'' \times 16'$	MDF/UL	39
MFPSHIP8 (1678737)	Shiplap	$\frac{1}{2}'' \times 7\text{-}\frac{1}{4}'' \times 16'$	MDF/UL	39
MFPTABOR3 (1567032)	Casing	$\frac{11}{16}'' \times 3'' \times 17'$	MDF/UL	24
MFPTABOR4 (1567033)	Baseboard	$\frac{9}{16}'' \times 4\text{-}\frac{3}{4}'' \times 16'$	MDF/UL	10
MFPTABOR7 (1567034)	Baseboard	$\frac{9}{16}'' \times 7'' \times 16'$	MDF/UL	10
1677196	Casing	$\frac{5}{8}'' \times 2\text{-}\frac{1}{4}'' \times 16'$	MDF/UL	22
MFPU8081 (1626213)	Casing	$\frac{5}{8}'' \times 3\text{-}\frac{1}{4}'' \times 16'$	MDF/UL	22
1677449	Baseboard	$\frac{1}{2}'' \times 5'' \times 16'$	MDF/UL	9
MFPU8281 (1626223)	Baseboard	$\frac{1}{2}'' \times 6'' \times 16'$	MDF/UL	9
MH049 (1556005)	Crown	$\frac{1}{2}'' \times 3\text{-}\frac{3}{16}'' \times \text{RL}$	H	28
MH180 (1556025)	Brick Mould	$1\text{-}\frac{3}{16}'' \times 1\text{-}\frac{15}{16}'' \times \text{RL}$	H	35
MH18007 (1556026)	Brick Mould	$1\text{-}\frac{3}{16}'' \times 1\text{-}\frac{15}{16}'' \times 7'$	H	35
MH1867 (1005608)	Hand Rail	$1\text{-}\frac{1}{2}'' \times 2'' \times \text{RL}$	H	37
MH204NG (1005039)	Hand Rail	$1\text{-}\frac{7}{16}'' \times 3\text{-}\frac{1}{2}'' \times \text{RL}$	H	37
MH206DG (1567053)	Hand Rail	$1\text{-}\frac{11}{32}'' \times 5\text{-}\frac{3}{16}'' \times \text{RL}$	H	37
MH206NG (1009639)	Hand Rail	$1\text{-}\frac{7}{16}'' \times 5\text{-}\frac{3}{8}'' \times \text{RL}$	H	37
MH231 (1556034)	Hand Rail	$1\text{-}\frac{7}{16}'' \times 1\text{-}\frac{5}{8}'' \times \text{RL}$	H	37
MH233 (1567056)	Rounds	$1\text{-}\frac{5}{16}'' \times 1\text{-}\frac{5}{16}'' \times \text{RL}$	H	36
MH311 (1008887)	Casing	$\frac{9}{16}'' \times 2\text{-}\frac{7}{16}'' \times \text{RL}$	H	25
MH31185 (1567060)	Casing	$\frac{9}{16}'' \times 2\text{-}\frac{7}{16}'' \times 7'$	H	25
MH346 (1567064)	Casing	$\frac{5}{8}'' \times 2\text{-}\frac{3}{16}'' \times \text{RL}$	H	22
MH34607 (1567065)	Casing	$\frac{5}{8}'' \times 2\text{-}\frac{3}{16}'' \times 7'$	H	22
MH352 (1003131)	Casing	$\frac{5}{8}'' \times 2\text{-}\frac{1}{2}'' \times \text{RL}$	H	24
MH35285 (1567067)	Casing	$\frac{5}{8}'' \times 2\text{-}\frac{1}{2}'' \times 7'$	H	24
MH356 (1556134)	Casing	$\frac{5}{8}'' \times 2\text{-}\frac{1}{4}'' \times \text{RL}$	H	21
MH35607 (1556135)	Casing	$\frac{5}{8}'' \times 2\text{-}\frac{1}{4}'' \times 7'$	H	21
MH3777 (1010462)	Casing	$\frac{11}{16}'' \times 3\text{-}\frac{1}{4}'' \times \text{RL}$	H	24
MH411 (1009360)	Casing	$\frac{11}{16}'' \times 3\text{-}\frac{1}{4}'' \times \text{RL}$	H	25
MH423 (1007109)	Baseboard	$\frac{1}{2}'' \times 5\text{-}\frac{1}{4}'' \times \text{RL}$	H	9
MH433 (1006054)	Casing	$\frac{9}{16}'' \times 3\text{-}\frac{1}{4}'' \times \text{RL}$	H	20
MH43308 (1567076)	Casing	$\frac{9}{16}'' \times 3\text{-}\frac{1}{4}'' \times 8'$	H	20
MH444V (1009986)	Casing	$\frac{5}{8}'' \times 3\text{-}\frac{1}{4}'' \times \text{RL}$	H	21

INDEX

Stock Code	Profile Type	Dimensions	Species	Page
MH47307 (1567080)	Casing	5/8" x 2-1/4" x 7'	H	20
MH618 (1556168)	Baseboard	1/2" x 3-1/4" x RL	H	15
MH623V (1567083)	Baseboard	1/2" x 3-1/4" x RL	H	15
MH6777 (1006363)	Baseboard	9/16" x 5-1/4" x RL	H	11
MH711 (1567085)	Baseboard	1/2" x 3-1/4" x RL	H	17
MH811 (1567087)	Baseboard	5/8" x 4-7/16" x RL	H	16
MH852 (1567088)	Baseboard	1/2" x 3-1/4" x RL	H	12
MH866 (1010933)	Door Stops	7/16" x 1-9/16" x RL	H	32
MH86607 (1556190)	Door Stops	7/16" x 1-9/16" x 7'	H	32
MH916 (1567094)	Door Stops	3/8" x 1-9/8" x RL	H	32
MH91607 (1567095)	Door Stops	3/8" x 1-9/8" x 7'	H	32
MH952 (1006774)	Baseboard	1/2" x 4-1/2" x RL	H	12
MHJ458F-VEN (1567102)	Jamb	11/16" x 4-5/8" x 82-3/16"	H	34
MHJ458F9712-VEN (1567100)	Jamb	11/16" x 4-5/8" x 98-3/16"	H	34
MHJ658F9712-VEN (1009550)	Jamb	11/16" x 6-5/8" x 98-3/16"	H	34
MHJ658K (1676282)	Jamb	1-3/16" x 6-9/16" x 83-1/2"	H	34
MHJ658K9812 (1668167)	Jamb	1-3/16" x 6-9/16" x 99-3/4"	H	34
MP047 (1382874)	Crown	9/16" x 4-9/16" x 16'	PFJ	28
MP049 (1567113)	Crown	1/2" x 3-5/8" x 16'	PFJ	28
MP10108 (1567118)	Cove	7/16" x 7/16" x 8'	PFJ	36
MP104SQ (1567120)	Flat Stock	21/32" x 3-1/2" x 16'	PFJ	33
MP105V (1567122)	Quarter Round	3/4" x 3/4" x 16'	PFJ	39
MP106SQT (1394311)	Flat Stock	21/32" x 5-1/2" x 16'	PFJ	33
MP108SQT (1394347)	Flat Stock	21/32" x 7-1/4" x 16'	PFJ	33
MP126 (1382473)	Baseboard Shoe	1/2" x 3/4" x 16'	PFJ	18
MP130507 (1382486)	Astragal	1-1/4" x 2" x 7'	PFJ	7
MP130508 (1567129)	Astragal	1-1/4" x 2" x 8'	PFJ	7
MP180V (1382605)	Brick Mould	1-1/4" x 2" x 17'	PFJ	35
MP180V07 (1567131)	Brick Mould	1-1/4" x 2" x 7'	PFJ	35
MP180V100 (1567134)	Brick Mould	1-1/4" x 2" x 8'	PFJ	35
MP248 (1382681)	Flat Stock	21/32" x 1-3/4" x 16'	PFJ	33
MP246 (1567140)	Flat Stock	21/32" x 2-3/4" x 16'	PFJ	33
MP311 (1567142)	Casing	5/8" x 2-1/16" x 14'	PFJ	25
MP32707 (1567149)	Casing	11/16" x 2-1/4" x 7'	PFJ	19
MP32716 (1567150)	Casing	11/16" x 2-1/4" x 16'	PFJ	19
MP346 (1567151)	Casing	5/8" x 2-1/4" x 14'	PFJ	22
MP34607 (1567152)	Casing	5/8" x 2-1/4" x 7'	PFJ	22
MP352 (1567154)	Casing	5/8" x 2-1/2" x 14'	PFJ	24
MP35207 (1567155)	Casing	5/8" x 2-1/2" x 7'	PFJ	24
MP356 (1567156)	Casing	5/8" x 2-1/4" x 14'	PFJ	21
MP35607 (1567157)	Casing	5/8" x 2-1/4" x 7'	PFJ	21
MP387 (1567158)	Casing	5/8" x 2-1/4" x 14'	PFJ	24
MP411 (1567161)	Casing	11/16" x 3-1/4" x 17'	PFJ	25
MP433 (1567164)	Casing	1/2" x 3-1/8" x 16'	PFJ	20
MP444V (1567166)	Casing	11/16" x 3-7/16" x 16'	PFJ	21
MP445 (1382846)	Casing	11/16" x 3-1/4" x 16'	PFJ	21
MP473 (1567170)	Casing	5/8" x 2-1/4" x 14'	PFJ	20
MP522V (1567174)	Baseboard	9/16" x 4-1/2" x 16'	PFJ	12
MP550 (1556322)	Crown	1-1/8" x 5-7/16" x 16'	PFJ	30
MP618 (1556324)	Baseboard	9/16" x 5-3/16" x 16'	PFJ	15
MP633 (1567179)	Baseboard	1/2" x 3-3/16" x 16'	PFJ	15

Stock Code	Profile Type	Dimensions	Species	Page
MP639 (1567181)	Baseboard	1/2" x 3-1/4" x 16'	PFJ	8
MP641 (1382551)	Baseboard	9/16" x 5-1/4" x 16'	PFJ	8
MP683 (1567183)	Baseboard	9/16" x 3-1/4" x 16'	PFJ	13
MP684 (1567185)	Baseboard	9/16" x 5-3/16" x 16'	PFJ	13
MP711 (1567186)	Baseboard	1/2" x 3-1/4" x 16'	PFJ	17
MP713 (1382973)	Baseboard	9/16" x 3-1/4" x 16'	PFJ	8
MP811 (1567189)	Baseboard	9/16" x 4-7/16" x 16'	PFJ	16
MP852 (1567190)	Baseboard	1/2" x 3-3/16" x 16'	PFJ	12
MP886 (1567191)	Door Stops	3/8" x 1-5/16" x 17'	PFJ	32
MP88607 (1567192)	Door Stops	3/8" x 1-5/16" x 7'	PFJ	32
MP916 (1567194)	Door Stops	3/8" x 1-9/8" x 17'	PFJ	32
MP91607 (1567195)	Door Stops	3/8" x 1-9/8" x 7'	PFJ	32
MP952 (1567196)	Baseboard	1/2" x 4-5/16" x 16'	PFJ	12
MPJ413F (1556341)	Jamb	11/16" x 4-13/16" x 98-3/16"	PFJ	34
MPJ413F9712 (1567199)	Jamb	11/16" x 4-13/16" x 98-3/16"	PFJ	34
MPJ413K (1556345)	Jamb	1-7/32" x 4-9/16" x 83-1/2"	PFJ	34
MPJ458F (1567202)	Jamb	11/16" x 4-5/8" x 82-3/16"	PFJ	34
MPJ458F9712 (1567204)	Jamb	11/16" x 4-5/8" x 98-3/16"	PFJ	34
MPJ458K (1567206)	Jamb	1-7/32" x 4-9/16" x 83-1/2"	PFJ	34
MPJ458K99 (1567207)	Jamb	1-7/32" x 4-9/16" x 99-3/4"	PFJ	34
MPJ514F (1567215)	Jamb	11/16" x 5-1/4" x 82-3/16"	PFJ	34
MPJ514K (1567216)	Jamb	1-7/32" x 5-1/4" x 83-1/2"	PFJ	34
MPJ658F (1567217)	Jamb	11/16" x 6-5/8" x 82-3/16"	PFJ	34
MPJ658F9712 (1567218)	Jamb	11/16" x 6-5/8" x 98-3/16"	PFJ	34
MPJ658K (1567219)	Jamb	1-7/32" x 6-9/16" x 83-1/2"	PFJ	34
MPJ658K99 (1567220)	Jamb	1-7/32" x 6-9/16" x 99-3/4"	PFJ	34
MPJ714K (1567227)	Jamb	1-7/32" x 7-1/4" x 83-1/2"	PFJ	34
MPJ714K99 (1567228)	Jamb	1-7/32" x 7-1/4" x 99-3/4"	PFJ	34
MPOPSCM1 (1567234)	Wainscott Cap	1" x 2-1/2" x RL	POP	41
MRO91607 (1567280)	Door Stops	3/8" x 1-3/8" x 7'	O	32
MROJ458F-VEN (1567281)	Jamb	11/16" x 4-5/8" x 82-3/16"	O	34
MSP047 (1382872)	Crown	9/16" x 4-9/16" x RL	PIN	28
MSP049 (1382883)	Crown	1/2" x 3-7/16" x RL	PIN	28
MSP052V (1382904)	Crown	9/16" x 2-5/8" x RL	PIN	28
MSP074 (1405323)	Bed Mould	9/16" x 1-3/4" x RL	PIN	35
MSP093 (1567289)	Cove	11/16" x 11/16" x RL	PIN	36
MSP09308 (1382341)	Cove	11/16" x 11/16" x 8'	PIN	36
MSP105 (1382360)	Quarter Round	11/16" x 11/16" x RL	PIN	39
MSP10508 (1599514)	Quarter Round	11/16" x 11/16" x 8'	PIN	39
MSP108 (1484135)	Quarter Round	1/2" x 1/2" x RL	PIN	39
MSP114 (1393438)	Wainscot Cap	5/8" x 13/16" x RL	PIN	41
MSP126 (1461861)	Baseboard Shoe	1/2" x 3/4" x RL	PIN	18
MSP12608 (1567299)	Baseboard Shoe	1/2" x 3/4" x 8'	PIN	18
MSP130507 (1567300)	Astragal	1-1/4" x 2" x 7'	PIN	7
MSP130508 (1567301)	Astragal	1-1/4" x 2" x 8'	PIN	7
MSP130808 (1567302)	Astragal	1-7/16" x 3-1/8" x 8'	PIN	7
MSP131507 (1567303)	Astragal	1-1/4" x 2" x 7'	PIN	7
MSP131508 (1567304)	Astragal	1-1/4" x 2" x 8'	PIN	7
MSP13708 (1567305)	Screen Mould	3/8" x 3/4" x 8'	PIN	39
MSP14208 (1382503)	Screen Mould	1/4" x 3/4" x 8'	PIN	39
MSP148 (1382508)	Glass Bead	3/8" x 3/8" x RL	PIN	37

INDEX

Stock Code	Profile Type	Dimensions	Species	Page
MSP163 (1461926)	Baseboard Cap	$1\frac{1}{16}'' \times 1\text{--}3\frac{3}{8}'' \times \text{RL}$	PIN	18
MSP180V (1567312)	Brick Mould	$1\text{--}1\frac{1}{4}'' \times 2'' \times \text{RL}$	PIN	35
MSP180V07 (1567313)	Brick Mould	$1\text{--}1\frac{1}{4}'' \times 2'' \times 7''$	PIN	35
MSP20408 (1567314)	Corner Guard	$1\text{--}1\frac{1}{4}'' \times 1\text{--}1\frac{1}{4}'' \times 8'$	PIN	27
MSP20508 (1510329)	Corner Guard	$1\text{--}1\frac{1}{16}'' \times 1\text{--}1\frac{1}{16}'' \times 8'$	PIN	27
MSP20608 (1567316)	Corner Guard	$1\frac{1}{16}'' \times 1\frac{1}{16}'' \times 8'$	PIN	27
MSP23908 (1567319)	Flat Stock-Square	$\frac{3}{4}'' \times \frac{3}{4}'' \times 8'$	PIN	33
MSP254 (1567320)	Parting Strip	$\frac{1}{2}'' \times \frac{3}{4}'' \times \text{RL}$	PIN	33
MSP25408 (1484627)	Parting Strip	$\frac{1}{2}'' \times \frac{3}{4}'' \times 8'$	PIN	33
MSP265 (1567322)	Lattice	$\frac{1}{4}'' \times 1\text{--}1\frac{1}{16}'' \times \text{RL}$	PIN	38
MSP26508 (1484631)	Lattice	$\frac{1}{4}'' \times 1\text{--}1\frac{1}{16}'' \times 8'$	PIN	38
MSP267 (1382690)	Lattice	$\frac{1}{4}'' \times 1\text{--}3\frac{3}{8}'' \times \text{RL}$	PIN	38
MSP26708 (1567325)	Lattice	$\frac{1}{4}'' \times 1\text{--}3\frac{3}{8}'' \times 8'$	PIN	38
MSP268 (1484635)	Lattice	$\frac{1}{4}'' \times 1\text{--}1\frac{1}{8}'' \times \text{RL}$	PIN	38
MSP26808 (1567327)	Lattice	$\frac{1}{4}'' \times 1\text{--}1\frac{1}{8}'' \times 8'$	PIN	38
MSP287LWM (1567328)	Decorative Mould	$1\text{--}1\frac{1}{8}'' \times 1\text{--}3\frac{3}{4}'' \times \text{RL}$	PIN	36
MSP29208 (1567330)	Wainscott Cap	$\frac{9}{16}'' \times 1\text{--}1\frac{1}{8}'' \times 8'$	PIN	41
MSP298 (1567331)	Chair Rail	$\frac{5}{8}'' \times 2\text{--}7\frac{1}{16}'' \times \text{RL}$	PIN	36
MSP327 (1567334)	Casing	$1\frac{1}{16}'' \times 2\text{--}1\frac{1}{4}'' \times \text{RL}$	PIN	19
MSP32707 (1567335)	Casing	$1\frac{1}{16}'' \times 2\text{--}1\frac{1}{4}'' \times 7''$	PIN	19
MSP346 (1567336)	Casing	$\frac{5}{8}'' \times 2\text{--}1\frac{1}{4}'' \times \text{RL}$	PIN	22
MSP34607 (1567337)	Casing	$\frac{5}{8}'' \times 2\text{--}1\frac{1}{4}'' \times 7''$	PIN	22
MSP356 (1567338)	Casing	$\frac{5}{8}'' \times 2\text{--}1\frac{1}{4}'' \times \text{RL}$	PIN	21
MSP35607 (1567339)	Casing	$\frac{5}{8}'' \times 2\text{--}1\frac{1}{4}'' \times 7''$	PIN	21
MSP433A (1567341)	Casing	$\frac{1}{2}'' \times 3\text{--}1\frac{1}{4}'' \times \text{RL}$	PIN	20
MSP444 (1567342)	Casing	$1\frac{1}{16}'' \times 3\text{--}7\frac{1}{16}'' \times \text{RL}$	PIN	21
MSP473WM (1567346)	Casing	$\frac{9}{16}'' \times 2\text{--}1\frac{1}{4}'' \times \text{RL}$	PIN	20
MSP618 (1382931)	Baseboard	$\frac{9}{16}'' \times 5\text{--}1\frac{1}{4}'' \times \text{RL}$	PIN	15
MSP633 (1567348)	Baseboard	$\frac{1}{2}'' \times 3\text{--}3\frac{3}{16}'' \times \text{RL}$	PIN	15
MSP634V (1567350)	Baseboard	$\frac{1}{2}'' \times 2\text{--}1\frac{1}{2}'' \times \text{RL}$	PIN	15
MSP713 (1567351)	Baseboard	$\frac{9}{16}'' \times 3\text{--}1\frac{1}{4}'' \times \text{RL}$	PIN	8
MSP71308 (1567352)	Baseboard	$\frac{9}{16}'' \times 3\text{--}1\frac{1}{4}'' \times 8'$	PIN	8
MSP726 (1567353)	Baseboard	$\frac{1}{2}'' \times 2\text{--}1\frac{1}{4}'' \times \text{RL}$	PIN	8
MSP85707 (1567355)	Door Stops	$\frac{3}{8}'' \times 1\text{--}1\frac{1}{4}'' \times 7''$	PIN	32
MSP87607 (1567357)	Door Stops	$\frac{7}{16}'' \times 1\text{--}3\frac{3}{8}'' \times 7''$	PIN	32
MSP87699 (1567358)	Door Stops	$\frac{7}{16}'' \times 1\text{--}3\frac{3}{8}'' \times 99''$	PIN	32
MSP91607 (1567362)	Door Stops	$\frac{3}{8}'' \times 1\text{--}3\frac{3}{8}'' \times 7''$	PIN	32
MSP995 (1416339)	Chamfer Strip	$\frac{3}{4}'' \times \frac{3}{4}'' \times \text{RL}$	PIN	35
MSPDM7 (1567366)	Panel Mould	$1\frac{1}{16}'' \times 1\text{--}5\frac{1}{16}'' \times \text{RL}$	PIN	38
MSPJ458F-VEN (1567369)	Jamb	$1\frac{1}{16}'' \times 4\text{--}5\frac{5}{8}'' \times 82\text{--}3\frac{3}{16}''$	PIN	34
MSPJ458K9812 (1567371)	Jamb	$1\text{--}7\frac{7}{32}'' \times 4\text{--}5\frac{5}{8}'' \times 99\text{--}3\frac{3}{4}''$	PIN	34
MSPJ658K (1567372)	Jamb	$1\text{--}7\frac{7}{32}'' \times 6\text{--}5\frac{5}{8}'' \times 83\text{--}1\frac{1}{2}''$	PIN	34
MSPJ658K9812 (1567373)	Jamb	$1\text{--}7\frac{7}{32}'' \times 6\text{--}5\frac{5}{8}'' \times 99\text{--}3\frac{3}{4}''$	PIN	34
MSPPM1 (1567374)	Panel Mould	$\frac{3}{4}'' \times 1\text{--}1\frac{1}{4}'' \times \text{RL}$	PIN	38
MSPPM5 (1567375)	Baseboard Cap	$\frac{5}{8}'' \times 1\text{--}1\frac{1}{16}'' \times \text{RL}$	PIN	18
MSPPM6V (1567377)	Panel Mould	$1\text{--}1\frac{1}{16}'' \times 1\text{--}13\frac{1}{16}'' \times \text{RL}$	PIN	38
SFR11212 (1567399)	Shelving	$1\frac{1}{16}'' \times 11\text{--}1\frac{1}{4}'' \times 12'$	MDF/UL	40
SFR11612 (1567402)	Shelving	$1\frac{1}{16}'' \times 15\text{--}1\frac{1}{4}'' \times 12'$	MDF/UL	40
SFR12412 (1567405)	Shelving	$1\frac{1}{16}'' \times 23\text{--}1\frac{1}{4}'' \times 12'$	MDF/UL	40
WP494 (1680480)	Casing	$\frac{9}{16}'' \times 3\text{--}1\frac{1}{4}'' \times 17'$	MDF/UL	20



EXPLORE OTHER PRODUCTS FROM METRIE®

In addition to our vast profile assortment, we offer unique product solutions that make it easy to select and install millwork.



Coordinated Collections of interior moulding that are professionally designed to ensure harmonious proportions, timeless beauty and perfect scale.



Curated moulding & interior door combinations that complement today's top décor trends.



Pre-painted & ready to install moulding solution that allows you to finish before you start.



METRIE® IS NORTH AMERICA'S LEADING MANUFACTURER AND DISTRIBUTOR OF INTERIOR FINISHINGS.

Our industry position has allowed us the resources, strength and leadership to create solutions that make it easier for consumers and design professionals to select, purchase and design with interior mouldings.

Metrie products distributed by:



13100 E. ALBROOK DRIVE, SUITE 200
DENVER, CO 80239
T: 303.371.8811 F: 303.371.8822
DENVERSALES@METRIE.COM

© 2018 Metrie® MET-480-DEN_0618 Printed in USA

METRIE.COM